



TEC EVENT CAMPUS

OLD INDUSTRY - MODERN EVENT SPACE

# TEC EVENT CAMPUS



## TEC EVENT CAMPUS

Wohlrabedamm 7 - 13629 Berlin

Mail [event@tec-event-campus.com](mailto:event@tec-event-campus.com)

Fon +49 30 470 807 00

[www.tec-event-campus.com](http://www.tec-event-campus.com)



TEC EVENT CAMPUS

## KEY FACTS

### **approx. 1.450 m<sup>2</sup> barrier-free indoor event space**

- daylight in each space
- non-equipped for the maximum of flexibility
- permissible floor load of 1.5 t per m<sup>2</sup>
- approved place of public assembly as defined by german law
- historical industrial building

### **approx. 2.900 m<sup>2</sup> outdoor space**

- 60 parking spaces  
additionally 2 parking spaces  
for people with disabilities



**Main entrance (stairs + lift) + outdoor gallery**  
> access to Front Hall



### **MAIN HALL - View to Front Hall**

> on the left side - gate to bring in vehicles (w280 cm x h310 cm)



TEC EVENT CAMPUS

## MEASUREMENTS + LIST PRICES

Location	Space	Height	Level	List price per day*
Entire venue	1.458 m <sup>2</sup>	up to 5,10 m	Ground floor	17.500 €
Entire venue incl. Outdoor	4.358 m <sup>2</sup>	-	Ground floor + Outdoor	20.500 €
Main Hall +	834 m <sup>2</sup>	up to 5,10 m	Ground floor	14.500 €
Front Hall	382 m <sup>2</sup>	up to 5,10 m	Ground floor	with Main Hall
Meeting 1	121 m <sup>2</sup>	up to 5,10 m	Ground floor	3.500 €
Meeting 2	121 m <sup>2</sup>	up to 5,10 m	Ground floor	3.500 €
Outdoor Front	1.100 m <sup>2</sup>	-	Outdoor	2.500 €
Outdoor Railway	1.800 m <sup>2</sup>	-	Outdoor	3.000 €
Catering	50 m <sup>2</sup>	3 m	Basement	free of charge
Storage 1	53 m <sup>2</sup>	3 m	Basement	750 €
Storage 2	38,5 m <sup>2</sup>	3 m	Basement	600 €









All specifications are subject to change and have to be inspected on-site.

\* All prices are net prices and are exclusive of VAT. Additionally we charge costs for power, water, staff and cleaning. 50% of the list price will be charged for set-up and dismantling days.

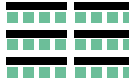
**Please let us know if renting TEC Event Campus is interesting for you.  
We would be pleased to draft you an individual offer.**

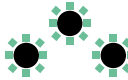

## SEATING VARIATIONS

Space	Stage								
		Pax		Pax		Pax		Pax	
Main Hall	ahead	800	8	442	4	621	6	505	5
Main Hall	side	800	8	453	5	614	6	535	5
Meeting 1		100	2	58	2				
Meeting 2		100	2	58	2				

The maximum capacity for the venue is 1.000 people. The seating numbers are benchmarks and may depend on the concept and set-up.



**MAIN HALL - view from Front Hall**

> main stage with LED wall ahead, chair rows, middle stage and stands for guests on the side



TEC EVENT CAMPUS

## OVERVIEW

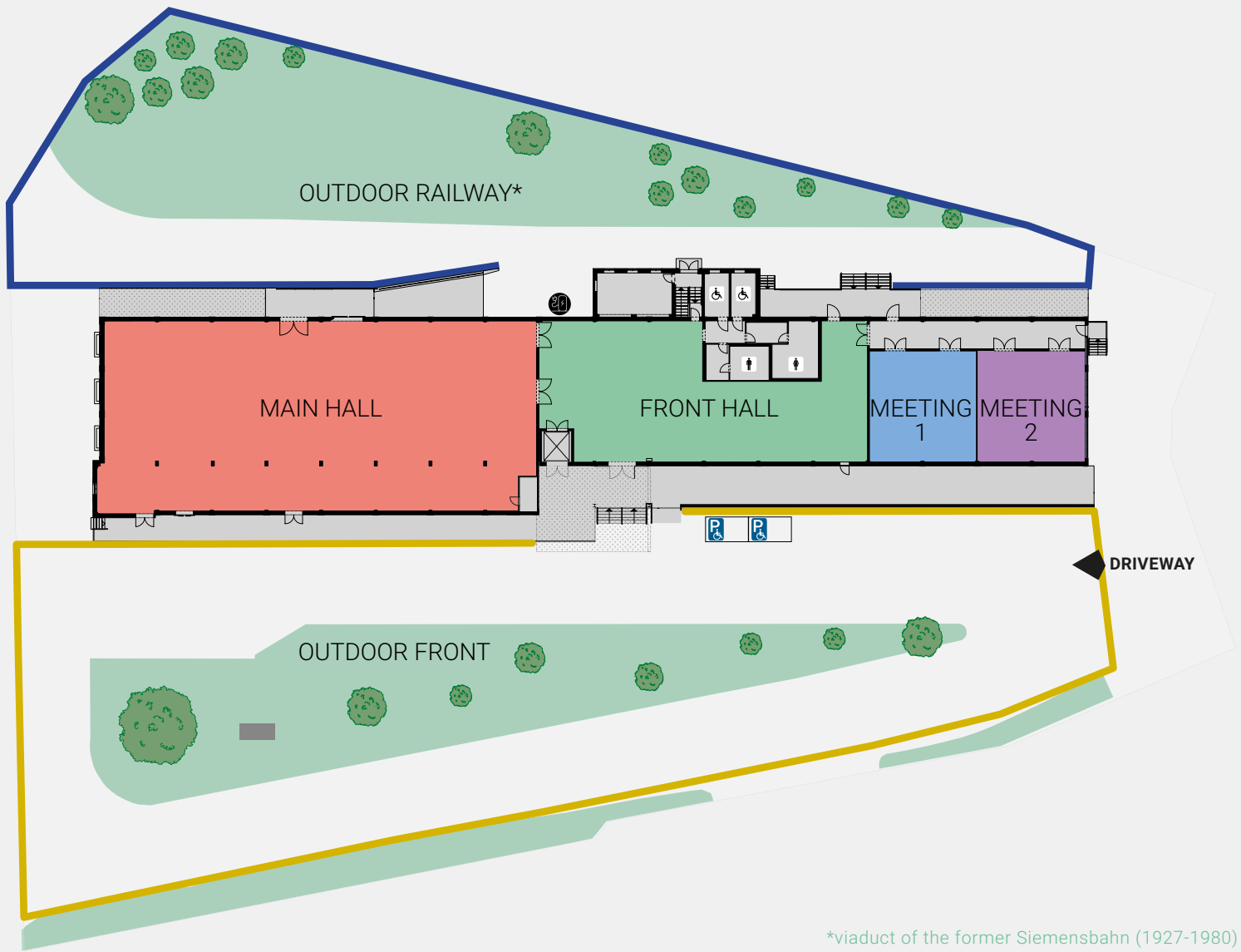

# FLOOR PLAN - GROUND FLOOR

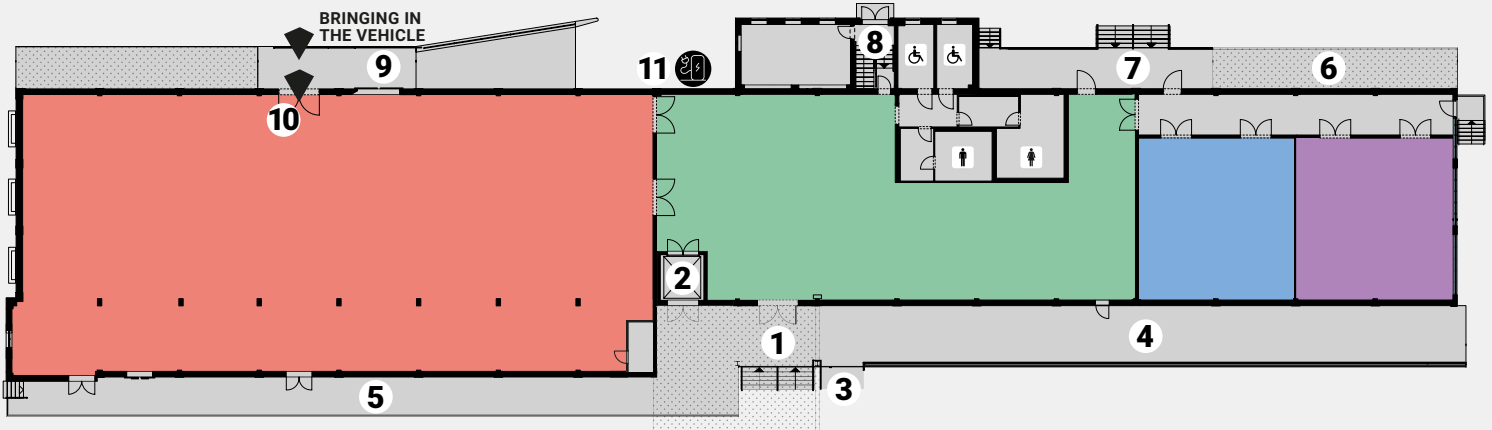

## ■ Main Hall

Space: 834 m<sup>2</sup>  
 Hight: up to 5,10 m  
 max. capacity: 1.000 people

## ■ Front Hall

Space: 382 m<sup>2</sup>  
 Hight: up to 5,10 m

### Access to the WC

Ladies - 9 cabins  
 Gentleman - 4 cabins + 6 urinals  
 barrier-free WC - 2

## ■ Meeting 1

Space: 121 m<sup>2</sup>  
 Hight: up to 5,10 m

## ■ Meeting 2

Space: 121 m<sup>2</sup>  
 Hight: up to 5,10 m

- 1 Main entrance with canopy
- 2 Goods lift (3t load) with a cess to the foyer and the space in front of the main entrance
- 3 Lift to the main entrance (length 1,43 m x width 0,90 m)
- 4 Ramp to the main entrance (10% gradient)
- 5 Outdoor gallery space (approx. 120 m<sup>2</sup>) with access to Main Hall
- 6 Ramp to storage space in the basement (12,5% slope)
- 7 Access to the Outdoor Railway
- 8 Staircase to basement
- 9 Access-ramp to Hall (10% gradient) with the possibility to bring in vehicles for presentation
- 10 Gate for bringing in vehicles (width 2,80 m x height 3,07 m)
- 11 wallbox (22 kW, incl. 6 m cable Typ2)



TEC EVENT CAMPUS

## FLOOR PLAN - BASEMENT

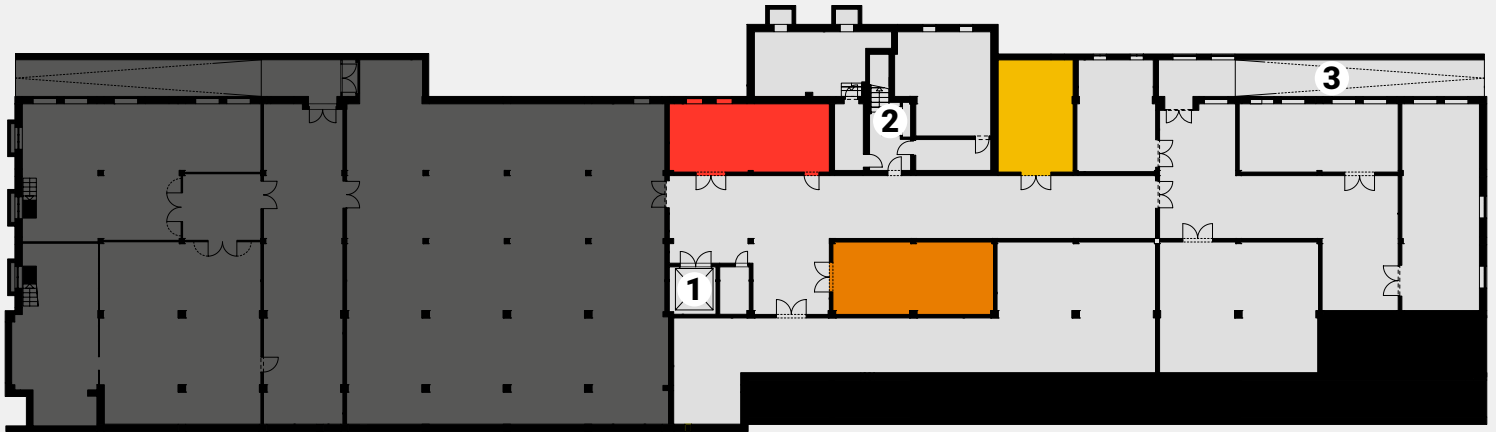

**Catering**

Space: 50 m<sup>2</sup>

Height: 3 m

**Storage 1**

Space: 53 m<sup>2</sup>

Height: 3 m

**Storage 2**

Space: 38,5 m<sup>2</sup>

Height: 3 m

1 Good lift (3t load)

2 Staircase to Front Hall

3 Ramp to the outdoor (12,5% gradient)

## SERVICES

### BEVERAGE CATERING



From a welcome coffee at the beginning of the event to a long drink during the get-together in the evening - our beverage packages offer you full flexibility and are created individually according to your event concept.

For saving valuable resources and in terms of sustainability, we do only serve our drinks from glass bottles and pay attention to social added value when selecting providers.

### BRANDING - BANNER



At TEC Event Campus we offer nine banner spaces along the facade of the venue, which can be used for event-related advertising as well as for presentations of partner logos or as press wall.

The main banner spaces ranging in size from 14.60 m<sup>2</sup> to 32.20 m<sup>2</sup> and facing the entrance to the TEC Event Campus area.

The other banners are located along the access way to the main entrance of the venue (see image).

### ALL-INCLUSIVE



At your request, we can handle the coordination, management and billing of partner services for event technology, food catering and equipment including decoration.

A handling fee will be charged for each final order of the respective partner services.

This allows us to offer you an almost all-inclusive package as part of the venue rental.

Event conception and guests management are excluded from this service.



## IMPRESSIONS



**Outdoor Railway**

> in the back - ramp to Main Hall



**Front Hall - view to the toilets cube**

> on the left side - access to Main Hall | on the right side - main entrance



**Meeting 1 - view from the corridor**

> lounge seating with stage



**Main Hall - access to Front Hall on the left side**

> mixed seating with stage

### VIRTUAL TOUR TEC EVENT CAMPUS





TEC EVENT CAMPUS

## OUR OTHER VENUES

### CAFE MOSKAU



At the heritage listed Cafe Moskau there are in total 12 event spaces from 60 m<sup>2</sup> to 446 m<sup>2</sup> on 2 floors.

The light-flooded Moskau hall (upper floor) and Almaty hall (ground floor) are the core of the venue.

Further there are two outdoor areas, Atrium and Rosengarten.

#### KEYFACTS

- 2.600 m<sup>2</sup> event space
- daylight in all event spaces
- up to 433 Pax in theater seating
- free of furniture, event technology and food catering
- capacity for 1.200 Pax
- mobile partition systems



\*Accessibility tested

**CAFEMOSKAU.COM**

**Address:** Karl-Marx-Allee 34 | 10178 Berlin

### SALON BABETTE



The former beauty salon „Babette“ was built in the early 1960s and is nowadays used as a bar and modern event spaces.

Room Madona (ground floor) is a multifunctional room with a fixed bar, lounge furniture and a event technology set-up.

Room Elva (upper floor) is setted as a lounge space.

#### KEYFACTS

- 126 m<sup>2</sup> event space
- fully glazed on 3 sides
- furniture by our partner Party Rent Berlin
- capacity for 100 Pax
- free of food catering

**SALONBABETTE.COM**

**Address:** Karl-Marx-Allee 34 | 10178 Berlin





TEC EVENT CAMPUS

## CONTACT + PARTNERS

### LOCATION

TEC Event Campus  
Wohlrabedamm 7  
13629 Berlin

### OFFICE

TEC Event Campus GmbH  
Milastraße 2  
10437 Berlin

### SECURITY

FSB-Security – Jörn Ullmann  
Mail joern.ullmann@fsb-security.com

### FURNITURE + DECORATION

Party.Rent – Juliane Seidel  
Mail juliane.seidel@party.rent  
Fon +49 30 200 061 525 8

### EVENT TECHNOLOGY

AMBION GmbH  
Christian Rathgeber-Fietzke + Lars Hiesener  
Mail tec@ambion.de  
Fon +49 30 726 278 412 1

### CATERING

Fuchs + Gans GmbH  
Gernot Karger + Paula Möhring  
Mail info@fuchsundgans.com  
Fon +49 30 804 935 69

Hoflieferanten Berlin  
Michael Lammert  
Mail lammert@hoflieferanten.berlin  
Fon +49 30 200 086 611

### REQUESTS + VISITS

Sales Team  
Mail event@tec-event-campus.com  
Fon +49 30 470 807 00

### PRODUCTION QUESTIONS

Productions Team  
Mail produktion@tec-event-campus.com

### HOTEL

Amano Group  
up to 10 rooms – Izabella Lugin  
Mail lugin@amanogroup.com

more than 10 rooms – Monique Belling  
Mail bellings@amanogroup.com

### DRIVER SERVICE

BerlinMobil Frank Richert GmbH  
Doreen Plischkaner  
Mail plischkaner@berlinmobil.de  
Fon +49 30 422 199 14

Kochbox-Event Berlin GmbH  
Katharina Müller  
Mail info@kochbox.com  
Fon +49 30 857 426 16

Wild & Wiese GmbH & Co. KG  
Ralf Dekorsy  
Mail ralf.dekorsy@wildundwiese.de  
Fon +49 30 657 779 01



TEC EVENT CAMPUS

## ARRIVALS

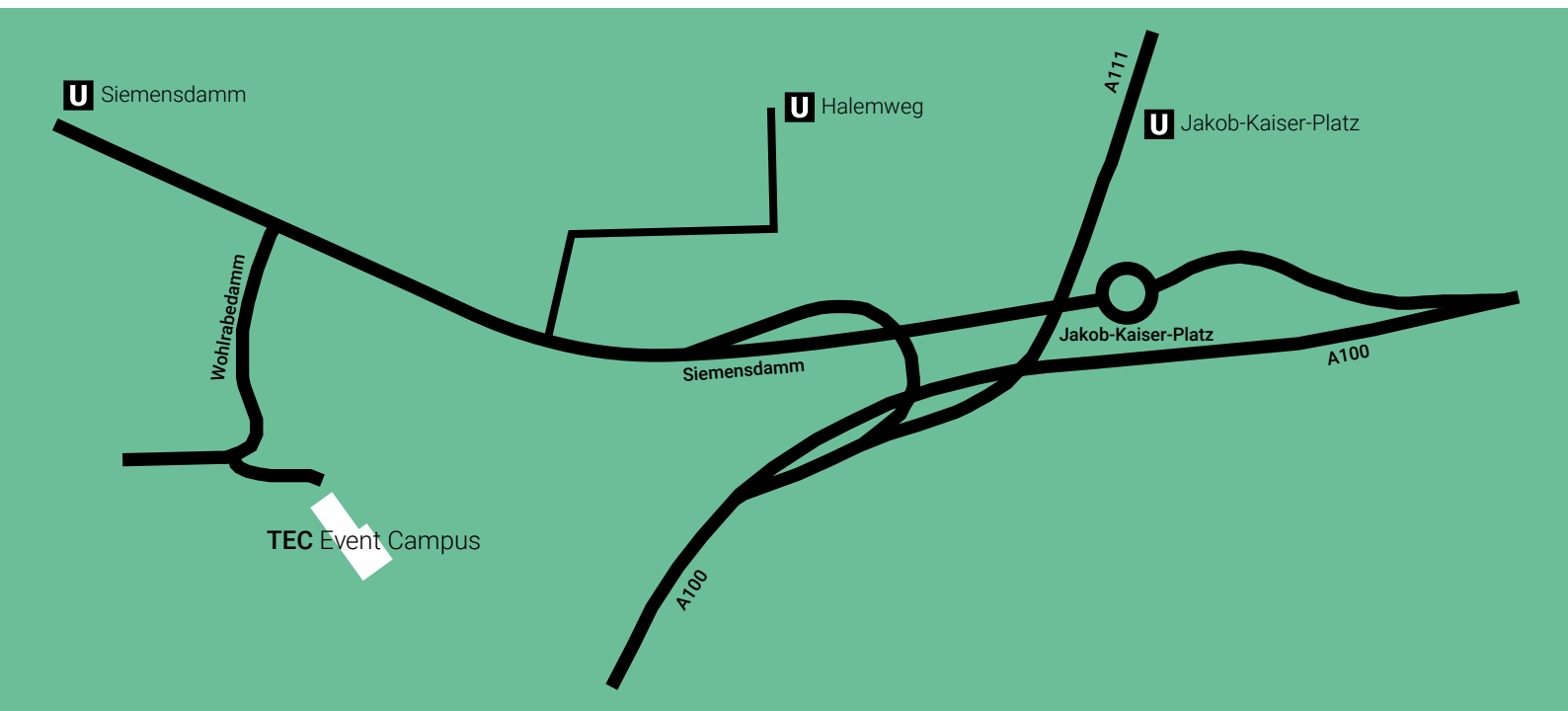

**TEC Event Campus** - Wohlrabadamm 7 - 13629 Berlin.

### Public transport

U-Bahnhof Siemensdamm (U7)  
U-Bahnhof Jakob-Kaiser-Platz (U7)  
U-Bahnhof Halemweg (U7)

### Arrivals

approx. 10 min from Messe Berlin  
approx. 40 min from BER Airport

### Parking

The outdoor space offers space for up to 60 vehicles.

Our member- + partnerships

Member of



Berlin  
Event  
Network

Partner of

