



# studios

Berlin's one-of-a-kind location for congresses, events and alike.





All Ears 



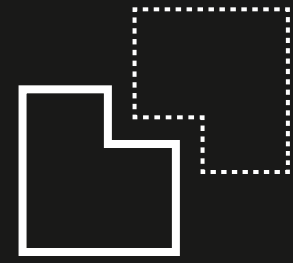

Modular event space of 8.000sqm

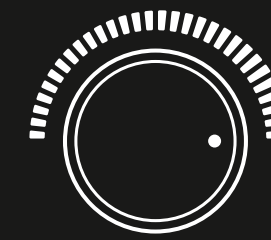

No noise or time limits

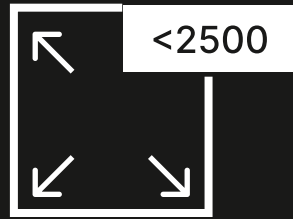

Additional extra large warehouse to host events up to 2.500 guests

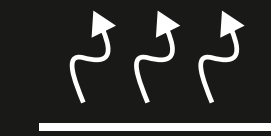

Floor heating system



Fibre-glas internet connection



Multiple high-voltage access points

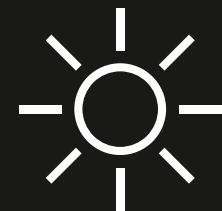

Daylight in all studios



State-of-the-art fire protection system



Available traverses in entire Studio 1



35 ready-to-use LED moving lights







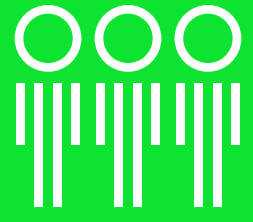

Available space for  
events up to  
**2.500**  
guests.

Hosting the  
extraordinary.

### → conferences

Main stage, second stage, workshops or panel discussion. Our four studios, three ateliers and the Oat Milk Studios provide everything you need for conferences up to 2,500 guests.

### → concerts & gala dinners

With its original vintage brick walls, combined with a variation of steel elements, the impressive STUDIO 1 provides a one-of-a-kind setting for unique social gatherings.

### → film works & foto production

Authentic industrial design elements create a unique ambience for film & foto productions. An enormous glass rooftop providing you with daylight as well as Berlin's largest infinity cove will set the stage for any kind of requirements you may have.

### → corporate events & product presentations

Your long awaited product launch, corporate dinner, Christmas event or company get-together.



#BRB



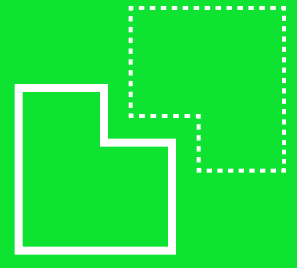

An ensemble of  
**four**  
traditional brick  
buildings.

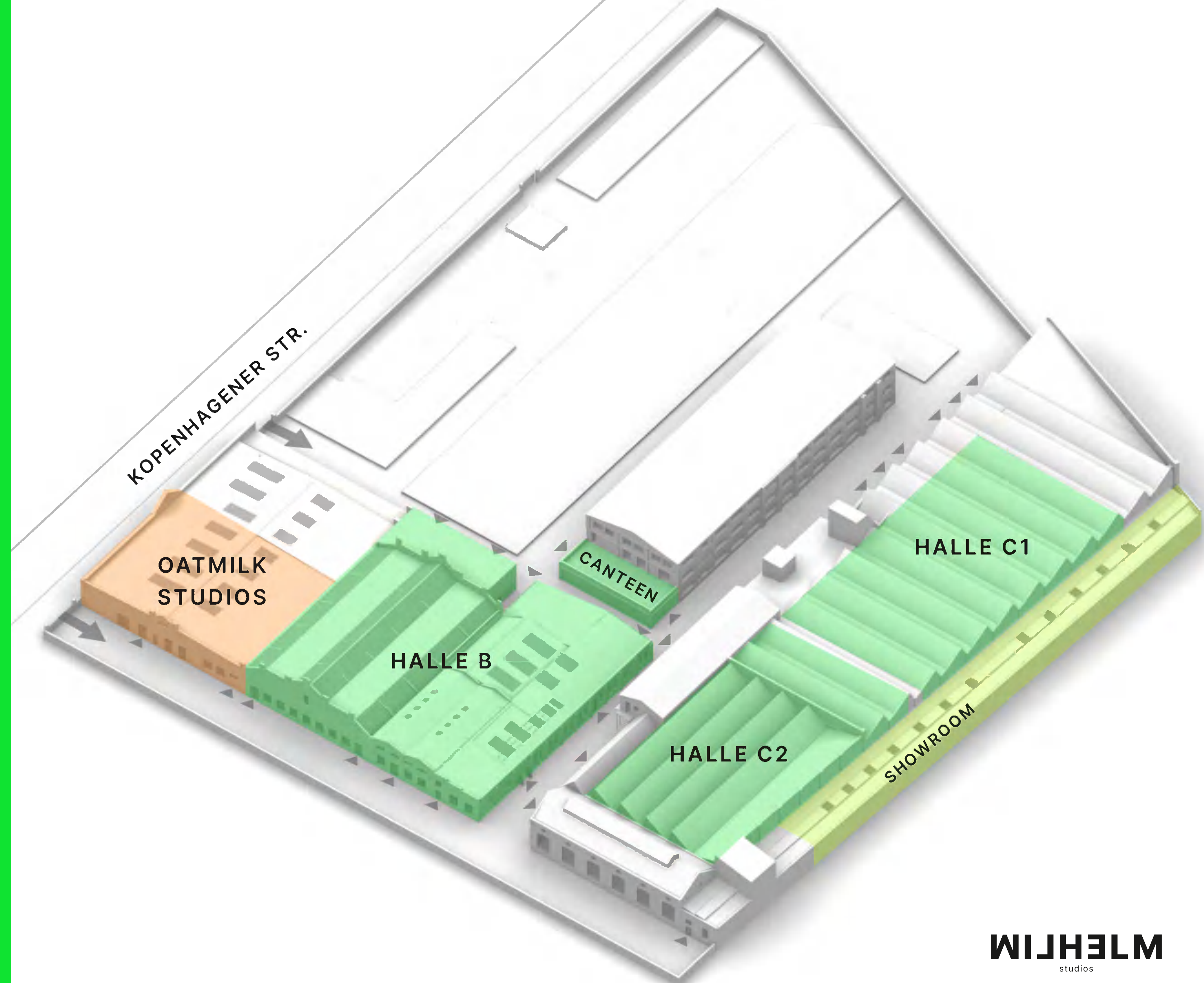



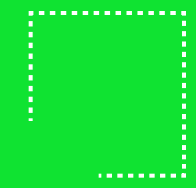

Grundriss

Wilhelm  
Studios

# LAYOUT





A spacious combination of 4 studios, right next to each other.

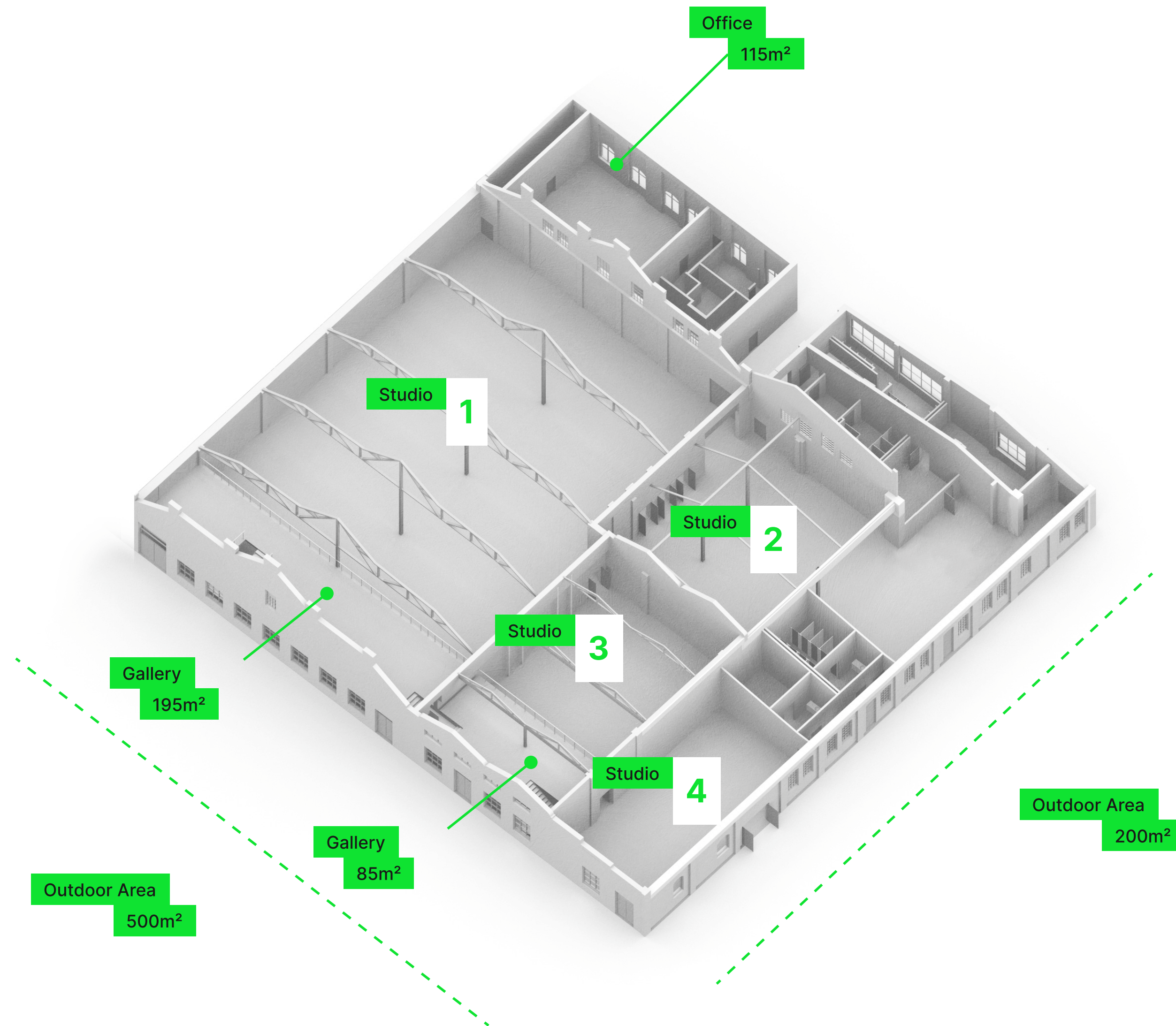

# WILHELM HALL B

→ key facts

- 4 studios from 170 to 1040sqm
- Main stage for up to 800 guests
- 500+ sqm outdoor area
- High-speed internet
- Light & music equipment on demand
- All rooms interconnected
- Expendable into Oat Milk Studios adding 700sqm floor space
- Production office and sanitary facilities directly attached

1	1042m <sup>2</sup>	2	417m <sup>2</sup>	3	288m <sup>2</sup>	4	171m <sup>2</sup>
TOTAL		2000m <sup>2</sup>					



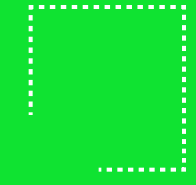

Layout

# Halle B

# LAYOUT







Out there.



The largest hall of the original iron foundry.  
Ready for the most extraordinary concepts.

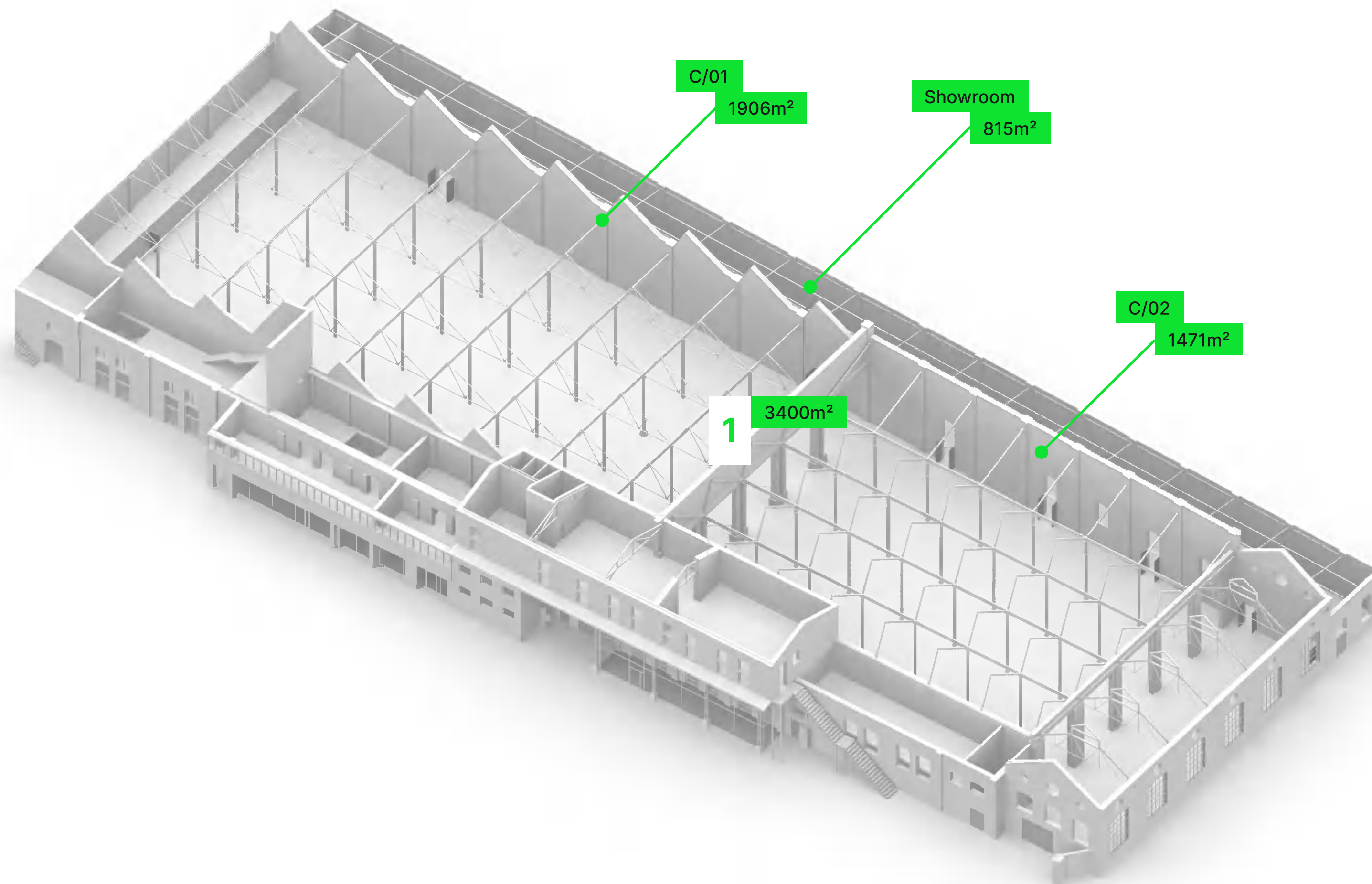

# C H A L L E

→ key facts

One single pillar hall with 3400sqm

Long 800sqm showroom with floor heating

15m to Halle B

Multiple use cases possible:

- Exhibitions
- Food markets
- Product presentations
- Fashion shows

1 3400m<sup>2</sup>







Additional high-quality space next door with all amenities needed.

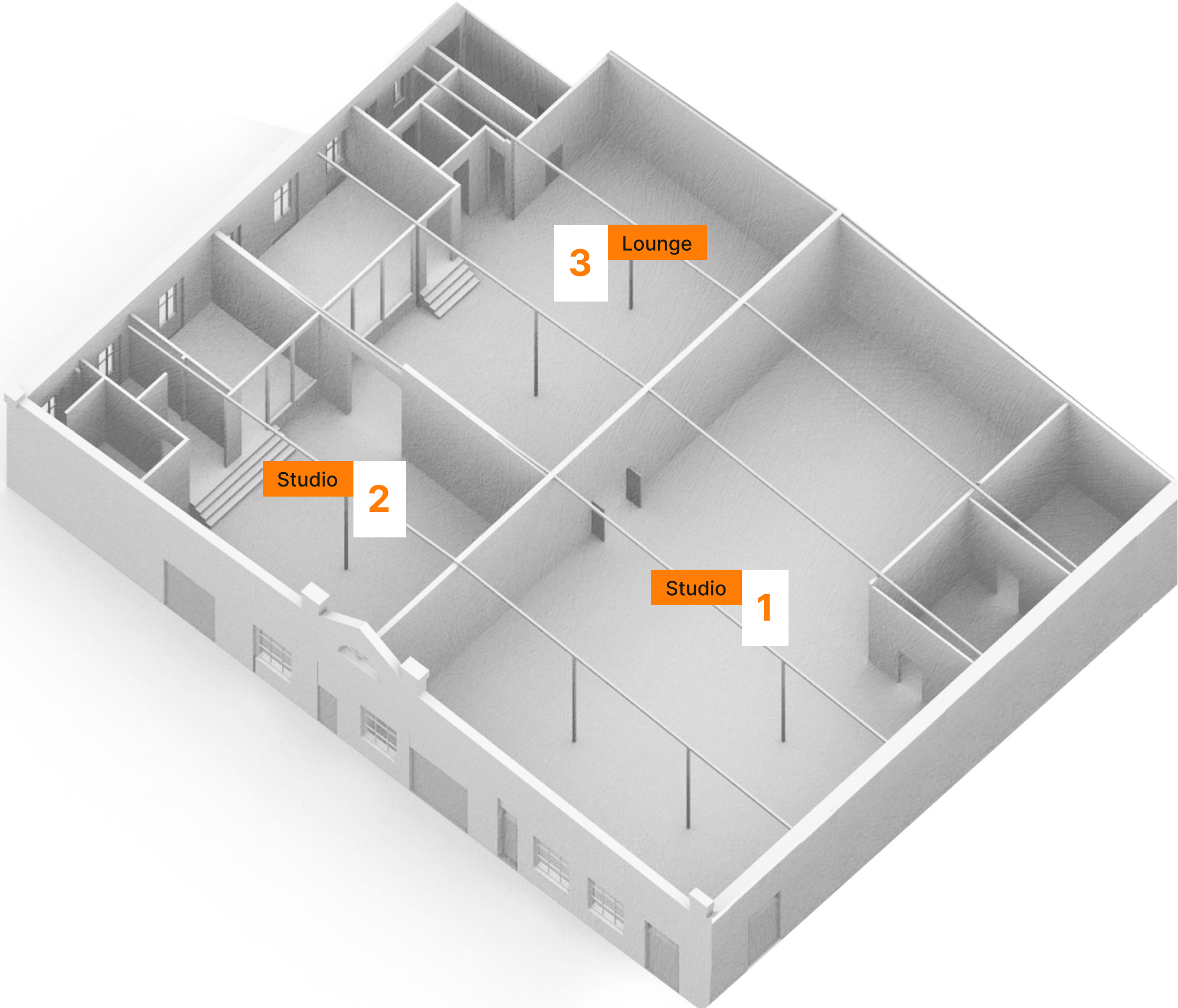

# OAT MILK STUDIOS

→ key facts

Oat Milk Studios as side stage or high-quality backstage area

Berlin's largest infinity cove to make your wildest dreams come true

Production offices and lounge area with well equipped kitchen

24 sqm changing room and bath room with 2 toilets and a separate shower

Up to 350 seated guests in main studio

Junior stage for up to 350 guests

1	285m <sup>2</sup>	2	125m <sup>2</sup>	3	186m <sup>2</sup>
---	-------------------	---	-------------------	---	-------------------

Total x m<sup>2</sup>



Oat Milk Studios



**WILHELM**  
studios



Freshly produced food & drinks. In-house.

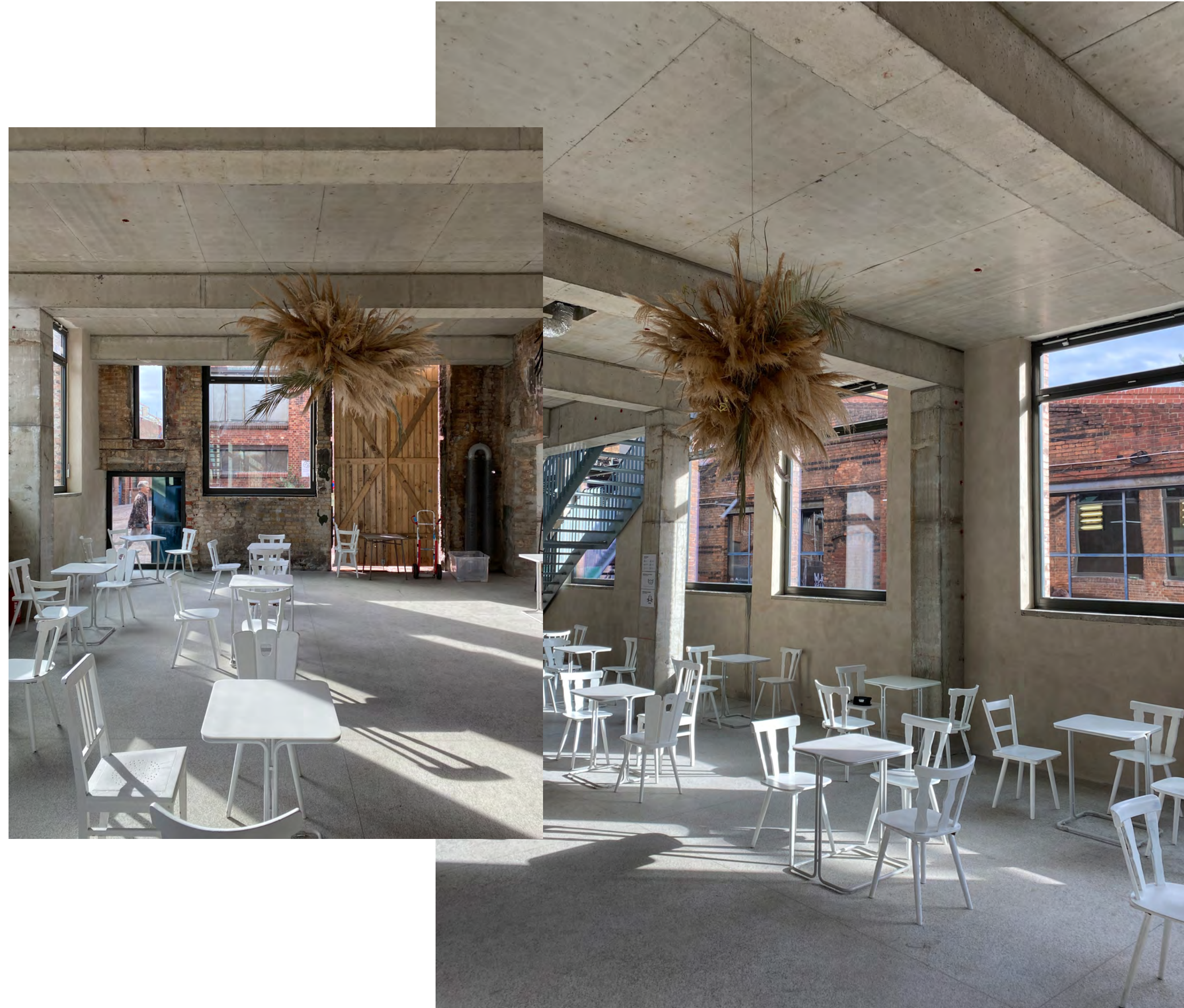

# CANTINEEN

→ key facts

300 sqm of catering area

80 sqm of production area

200 sqm rooftop terrace

Pre-installed kitchen appliances



Yes to all. Because we have it all.



# SERVICES

→ key facts

Gastronomy

Catering

Culture & music booking

Setdesign

Art Directon



Supported by TLT Event AG.



# EVENTTECH

→ services

Consulting

Light engineering

Sound engineering

Videotech

CAD-Planing

Rigging

Streaming services

High speed fibre optic internet



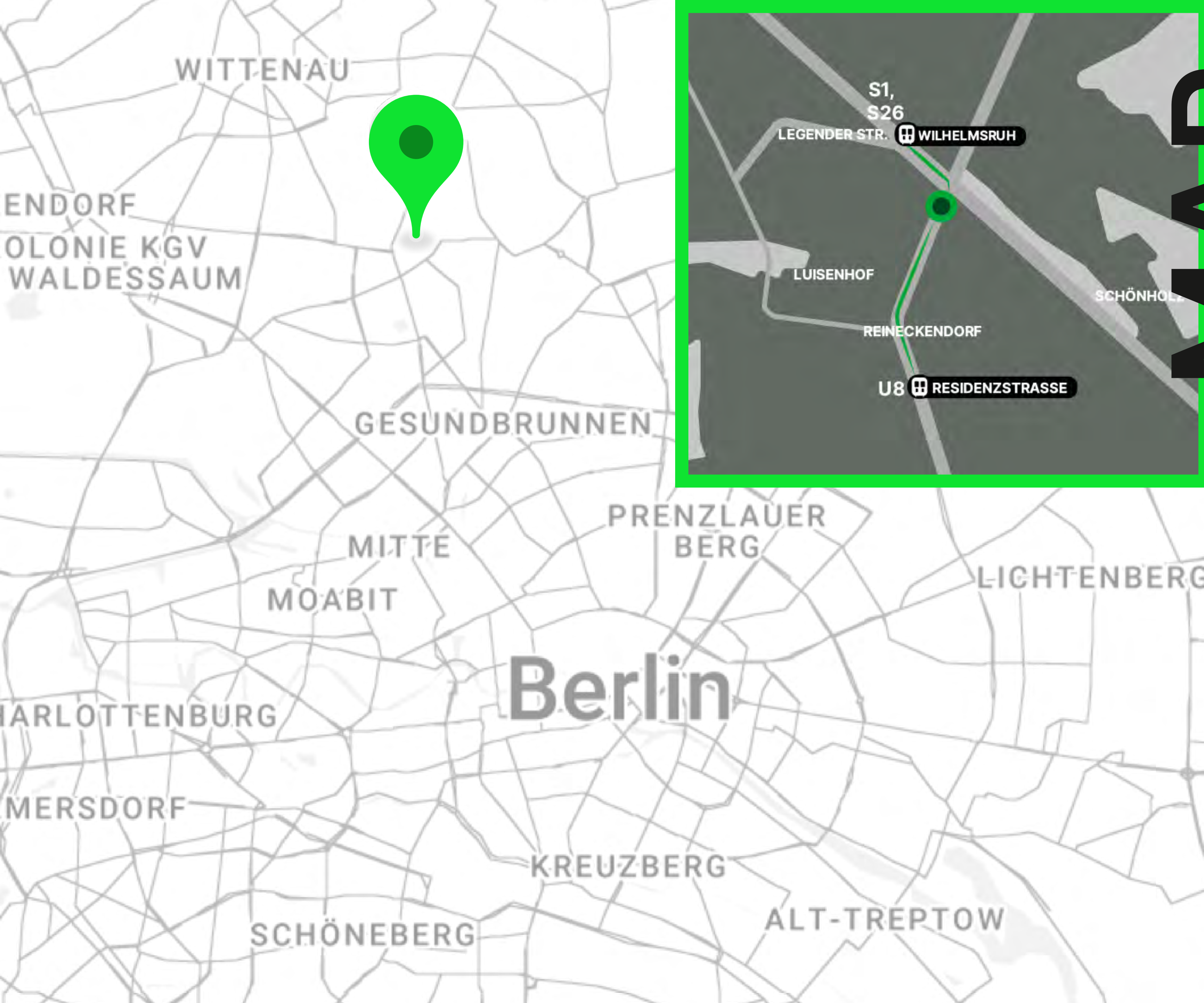

## → key facts

S.Bahnhof Wilhelmsruh (S1 Oranienburg-Wannsee) approx. 50 meter

U-Bahnhof Residenzstraße (U8 Wittenau-Hermannstraße) approx. 900 meter

Bus Stop line 122 approx. 50 meter

12 minute with the S-Bahn to S-Bahnhof Friedrichstraße

15 minute car drive to Berlin Mitte Alexanderplatz

Connection to B96 approx. 350m

Motorway access Kurt-Schumacher Platz (A111) approx. 1900 meter

[On Google Maps](#)







# CONTACT

MARIANNA PINOL GARCIA

+49 151 25367280

BJÖRN WÖSTEN

+49 176 66624319

QUIRIN SCHWANCK

+49 176 72748493

[wilhelmstudios.de](http://wilhelmstudios.de)

[info@wilhelmstudios.de](mailto:info@wilhelmstudios.de)