

spindler  klatt

24 EVENT



THE THOUGHT

The Spindler & Klatt is a multifunctional catering concept

Restaurant, club and event location that meets the highest functional and aesthetic demands. The focus is on reducing to the essentials. Original Asian antiques were combined with a puristic, clear furniture concept.

The flexibly positionable furniture elements, the extensive sound and light-

ing technology, as well as the projection surfaces let Spindler & Klatt shine in a suitable atmosphere for every type of event. The implementation of Spindler & Klatt is based on the idea of a studio, a microcosm in the metropolis of Berlin directly on the Spree and directly on the former east-west border.

Typically Berlin – confident, convertible, creative and international.



AREA RESTAURANT

Our approximately 350 m² Restaurant is fitted with sand white curtains, which create a stylish, warm atmosphere. The 36 fixed installed “screens” can be recorded with your logos, image movies and other visuals.

Thanks to our flexible furniture concept, we can adapt the setup entirely according to your wishes and requirements. This enables us to create space for up to 500 people in a mixed seating or for up to 200 people in a gala seating.

The 48 m² stage also allows us to create space for concerts or other performances and shows.

A ceiling height of approx. 10 meters is ideal for aerial and rope cloth acrobatics to make your event something very special for you and your guests.

We would be happy to provide you with suggestions for various entertainment options.



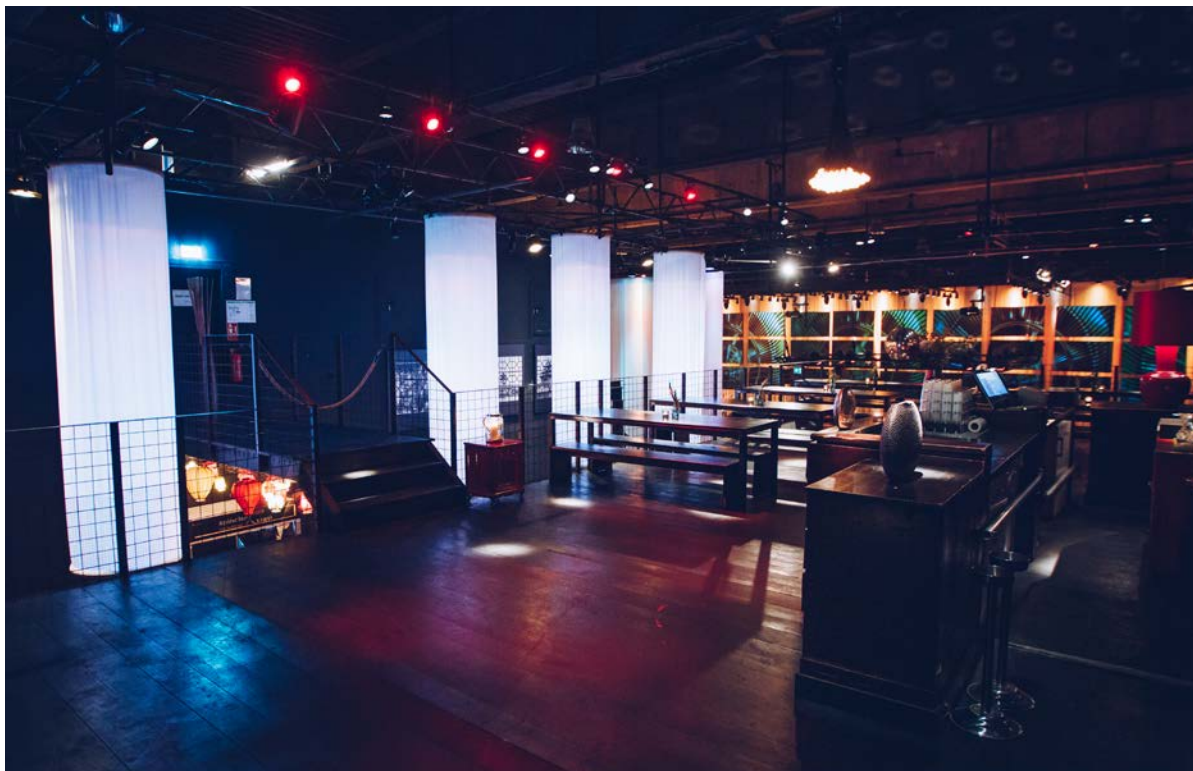

AREA THE GALLERY

The gallery is located on top of the overseas containers in which the cloakrooms and toilets are housed. It can be used as a separate area with its own bar and offers guests a great view of the restaurant.

The area is primarily furnished with lounge furniture and bar tables, but can be designed

in any setup variant thanks to the modular design. From long tables, tables, banquet seating or exclusively with standing tables as a separate party area, everything is possible.

With a capacity for up to 150 guests, this area is very suitable for smaller groups.





AREA THE CLUB

While the restaurant impresses with its size and clear lines, the club is small, compact and cozy.

In the approximately 165 m² room, the Asian sculptures and the long bar are in the foreground.

A warm lighting mood, the light bulb walls and the low ceiling height create a pleasant club atmosphere for approx. 250 guests.

This area can also be used as a separate VIP-Area can be used or as a second dance floor.





AREA THE WOOD LOUNGE

The entrance area is approx. 250 m² and unroofed. The lounge landscapes, beach chairs and the waterfall invite you to relax right by the Spree.

When there's good weather the BBQ stations provide a real summer feeling in the middle of the big city.

In winter, tent tunnels are built on the Wood Lounge to be able to handle the wardrobe logistically easier at big events. This way, the guests can directly enter the heated winter terrace after handing in their jackets and coats

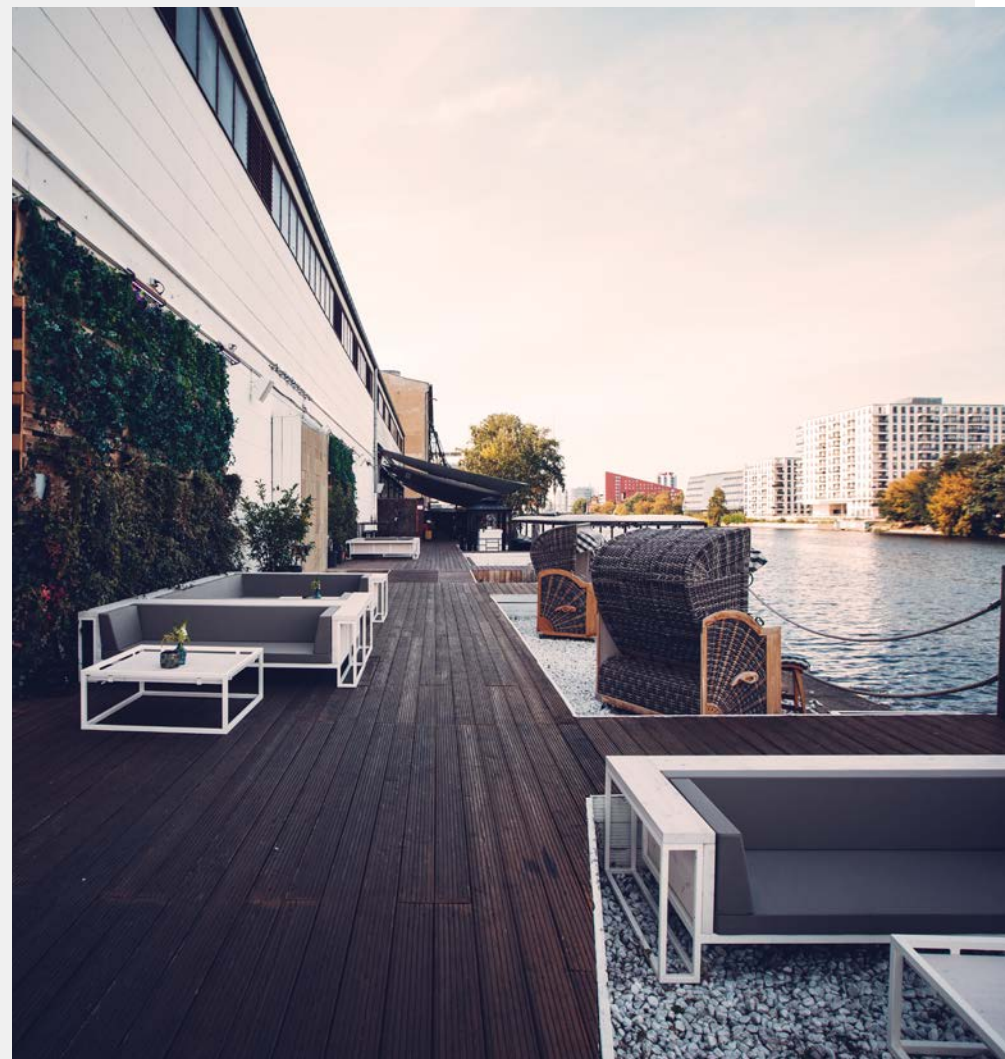

AREA THE TERRACE

The terrace area directly on the Spree has a usable area of approx. 200 m² and offers space for dinner for approx. 180 guests, for events even for up to 300 guests.

In summer the terrace is covered with white Ibiza sails. They offer protection from rain or sun and make it possible to make optimal use of the area in all weather conditions.



For the winter, a winter garden made from transparent planet funnels terrace was conceptualized specially for this terrace. The terrace is heated and can therefore also be used for events in winter. It creates the spectacular feeling of being outdoors on the Spree in the middle of the winter.

Due to the independent terrace bar, the paths for guests are always short.

AREA THE PONTOON

The former coal tugboat has been rebuilt to shine again with a new look and offers your guests an unforgettable view of the Oberbaum-bridge, the TV tower and the East Side Gallery - three of Berlin's most famous sights. With only two steps, you get from the terrace down to the covered "swimming Restaurant", which offers space for approximately 120 guests.

The Pontoon has its own bar and here too, you find the design of flexibly moveable tables, chairs and lounge benches.

The guests are not only by the Spree, they are directly on the Spree, which makes the Pontoon one of the most attractive event spaces in Berlin.

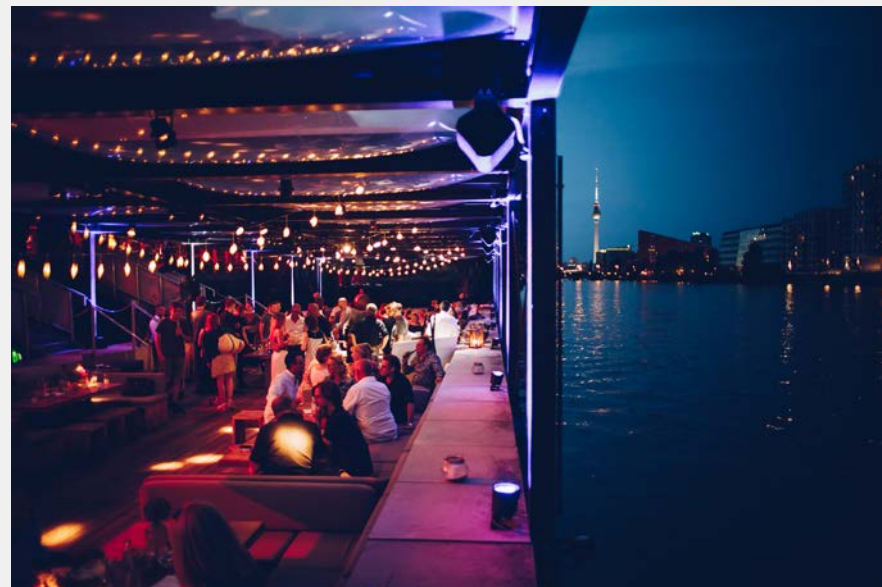
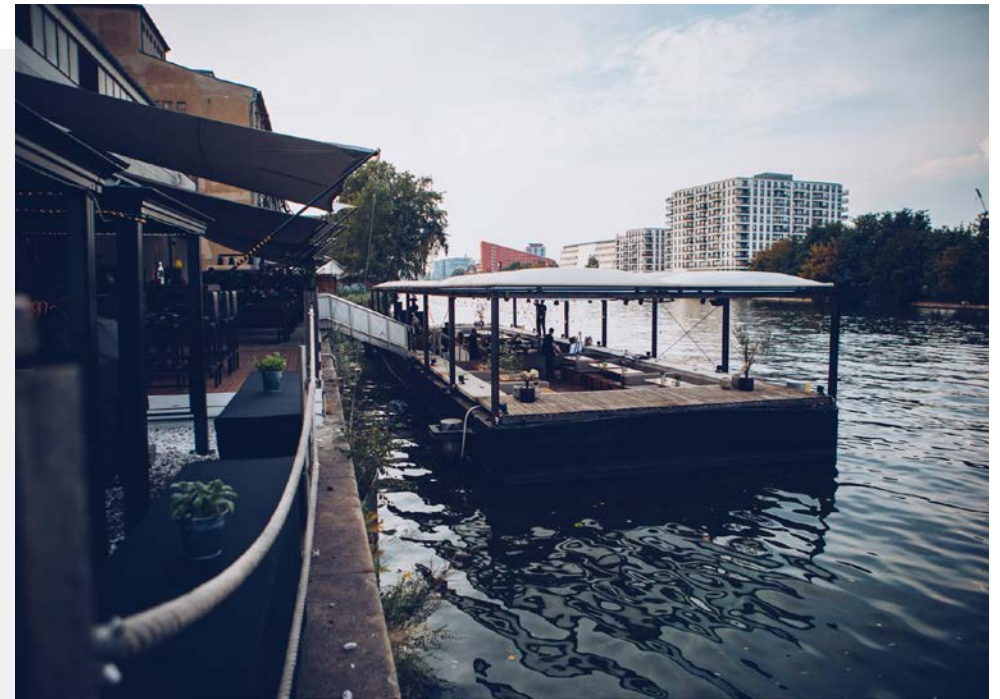

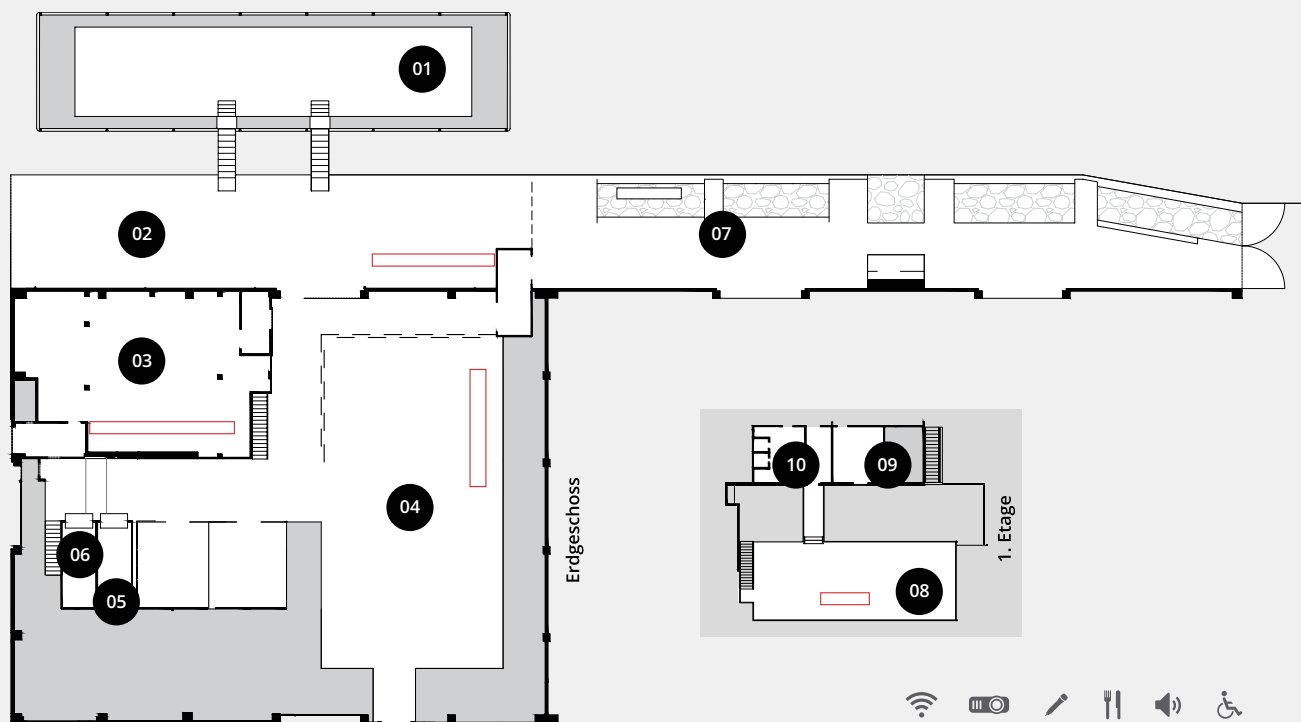

THE LOCATION

- 01 Pontoon
- 02 Terrace
- 03 Club
- 04 Restaurant
- 05 Wardrobe 1
- 06 Wardrobe 2
- 07 Wood Lounge
- 08 Empore
- 09 Backstage 1
- 10 Backstage 2
- Bar

Room layout / Seating arrangements (room)

Roomname	Greeting 🍷	Gala 🌟	Banquet 🍽️	U-Form 📺	Parlament 🏛️	Lines 📊	Area (m²)
Restaurant	600	220	300	-	150	302	280
Terrace	300	90	180	-	-	-	255
Club	200	-	-	-	30	50	165
Empore	150	50	90	-	-	70	100
Pontoon	200	90	125	-	-	-	160
Wood Lounge	250	-	-	-	-	-	340

THE CLUBRESTAURANT

The restaurant of the Spindler & Klatt offers its guests culinary brilliance. The kitchen team uses fresh ingredients with guaranteed highest quality for the Pan-Asian-European kitchen. The summer terrace and the floating pontoon not only offer an invaluable view of the Spree, but are also the perfect backdrop for an unforgettable dinner.

At the weekends, the location turns into a smooth transition from a dinner atmosphere to a club with many options.





THE CATERING

In addition to the exclusive event location, the pan-Asian restaurant and the club, Spindler & Klatt also offers individual catering for all types of events. The kitchen is based on many years of event and catering experience. The range of dishes is individually designed and created with each event; In addition, it is possible to choose from a selection of menus and buffets which have been previously very well received.

AGENCY SERVICE

At the heart of the agency is the exclusive design and marketing of three design event locations in Berlin.

» **Spindler & Klatt**

- » The Grand
- » Haus Ungarn

The agency supports the locations starting with important interior-specific decisions up to the actual marketing and event implementation in the respective rooms.

24/7 Event - We serve every customer idea and bring in our experience in design, planning and implementation. In addition to extremely thorough

pre-planning and creative ideas, our quality is characterized by flexibility and always professional reaction in critical and stressful situations.

As an agency, 24/7 Event combines design, planning, implementation, event management, conception, press and public relations, invitation management, catering, personnel placement and VIP support to form a holistic and sustainable event concept. Our network, which has grown over the years, will find a feasible answer to any of your requirements or ideas.



REFERENZEN



It really has been great to work with you and I appreciate all the time and attention you have given and provided in ensuring it was all to perfection...

Colliers EMEA



The food was really excellent and the selection was huge. Our guests were well looked after and especially the service was great.

Sky



Thank you for your great commitment, excellent communication and professional support.

We would love to come back!

Rakuten



Everyone felt in good hands, they enthusiastically tell about the buffet, the friendly staff, the many lovingly designed details and of course the great atmosphere.

Talpa Germany





IMPRESSIONS

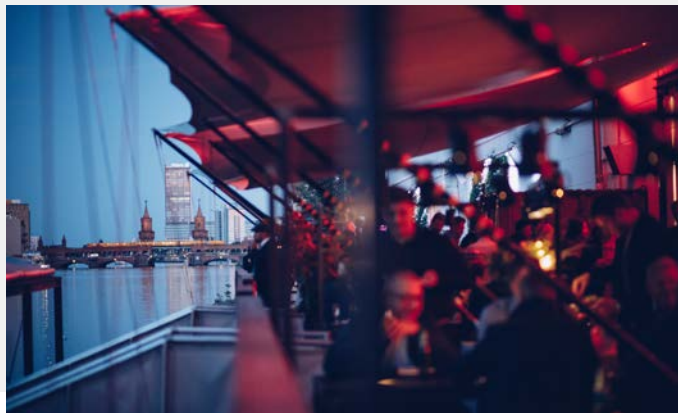

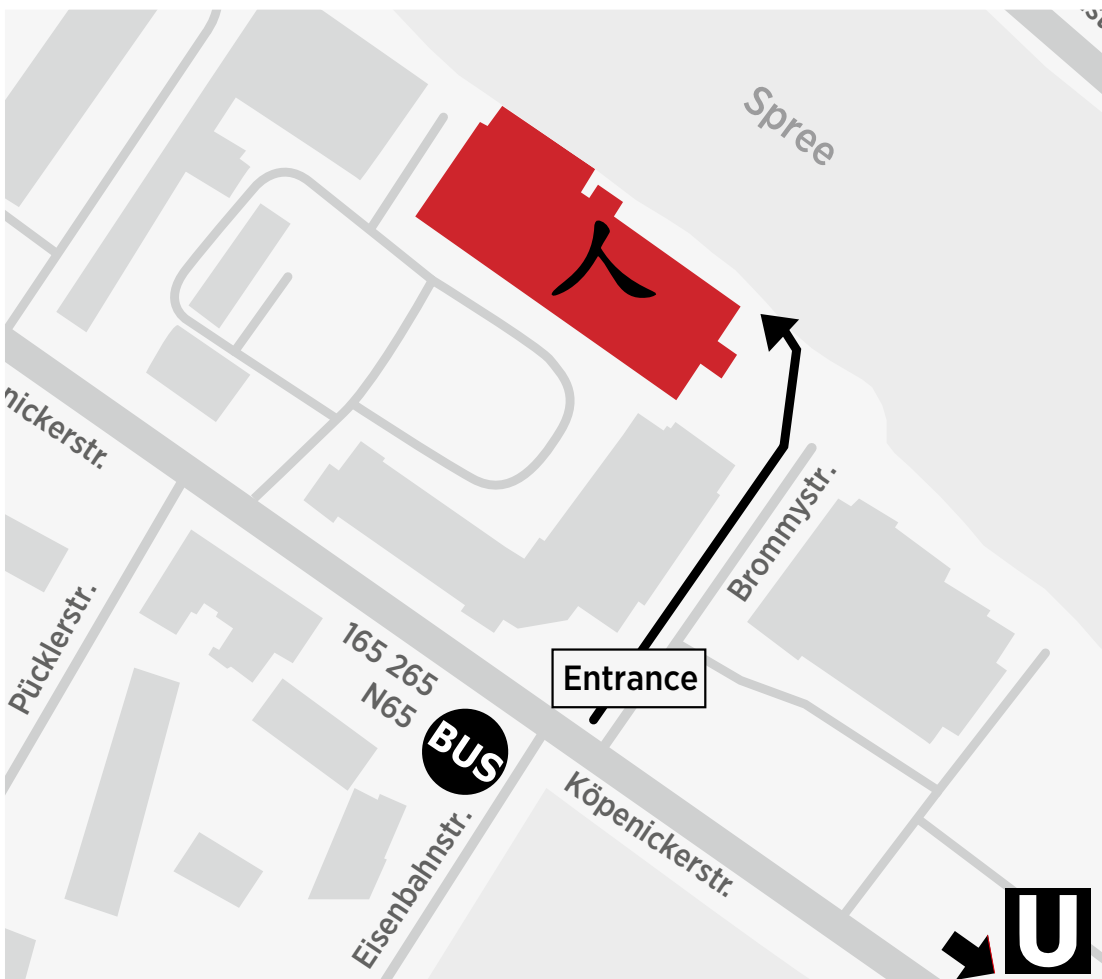

CONTACT

24/7 Event GmbH
Köpenicker Straße 16-17
10997 Berlin

Tel.: 030 - 319 88 18 60
Fax: 030 - 319 88 18 60

office@spindlerklatt.com
office@24-7event.com

www.spindlerklatt.berlin
www.24-7event.com