



CAFE MOSKAU



**PURE ELEGANCE MEETS HISTORY
WITH MODERN INFRASTRUCTURE**

Cafe Moskau
Karl-Marx-Allee 34
10178 Berlin
www.cafemoskau.com

Fon: +49.30.470 807 77
event@cafemoskau.com

EVENT SPACES



This architectural icon was built in 1964 on one of the capital's most popular streets: Karl-Marx-Allee in the heart of Berlin.

As a wine bar, nightclub and tea shop, the property was an eclectic mix of everything and a central meeting place for A-listers. After extensive renovations, the former restaurant re-opened in 2009 as a multi-purpose venue.

The heritage-listed establishment is particularly distinguished by its historic elements. Numerous details have been preserved from its early years giving it an unique charm. These include the elaborate wall mosaics, the illuminated lettering and the Sputnik satellite at the main entrance.

The floor-to-ceiling windows and atrium style are additional trademarks of the building, whose light-filled rooms offer patrons generous, unparalleled transparency.



EVENT SPACES



Almost 2,600 sq m of function space stretches over three floors providing enough room to hold any kind of event.

The heart and soul of the venue are the two large halls - „Almaty“ on the ground floor and „Moskau“ (Moscow) on the upper level.

10 more rooms offer lots of space for workshops, lounges, buffets and much more.

To guarantee you maximum flexibility the entire venue comes without furniture and almost all rooms feature mobile partition systems, which enable easy modifications and variations.

A curtain system with blackout curtains allows to darken the rooms for projections.

The Cafe Moskau includes two popular outdoor areas, which are ideal for receptions, catering and breaks outdoors.

The Atrium in the center of Cafe Moskau and enables direct access to the foyers, the hall Almaty, and the rooms Jerewan (Yerevan), Duschanbe (Dushanbe) and Bischkek (Bishkek).

The Rosengarten (rose garden) with its very own charm, water feature and roses enables direct access to the rooms Asgabat, Duschanbe (Dushanbe) and Jerewan (Yerevan).

Get impressed by the charm of Cafe Moskau and arrange a site inspection with our team.



We are looking forward to welcoming you!

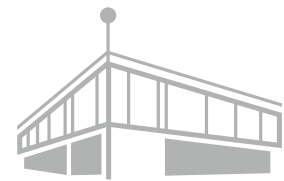

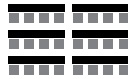

CAFE MOSKAU
BERLIN

MEASUREMENTS & SEATING OPTIONS

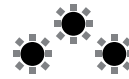
| LOCATION | SPACE | HIGHT |  |  |  |  | LIST PRICES PER DAY* |
|------------------------|----------------------------|--------|---|---|---|---|-------------------------|
| floor 1 & 2 | 3.135 m² | | | | | | 19.500 € |
| Ground floor | | | Pax | Pax | Pax | Pax | |
| Almaty | 382 m ² | 3,50 m | 375 | 182 | 288 | 230 | 5.000 € |
| Asgabat | 160 m ² | 3,50 m | 141 | 72 | 108 | 100 | 2.500 € |
| Duschanbe | 67 m ² | 3,50 m | 24 | 15 | 24 | - | 1.500 € |
| Jerewan | 67 m ² | 3,50 m | 20 | - | - | 20 | 1.500 € |
| Bischkek | 81 m ² | 3,50 m | 78 | 30 | 42 | 40 | 1.500 € |
| Foyer Baku | 105 m ² | 3,50 m | - | - | - | - | - |
| Foyer Taschkent | 73 m ² | 3,20 m | - | - | - | - | - |
| Office | 19,50 m ² | 3,50 m | | | 8 | | |
| Upper floor | | | | | | | |
| Moskau | 446 m ² | 3,90 m | 433 | 232 | 378 | 280 | 5.000 € |
| Vilnius | 66,50 m ² | 3,50 m | 64 | 25 | 36 | 30 | 1.500 € |
| Tallinn | 60 m ² | 3,50 m | 46 | 24 | 30 | 30 | 1.500 € |
| Riga | 65 m ² | 3,50 m | 46 | 24 | 30 | 30 | 1.500 € |
| Minsk | 88 m ² | 3,50 m | 63 | 34 | 36 | 30 | 1.500 € |
| Chisinau | 112 m ² | 3,50 m | 108 | - | - | - | 1.500 € |
| Foyer Kiew | 113,50 m ² | 3,50 m | - | - | - | - | - |
| Foyer Tiflis | 69 m ² | 3,50 m | - | - | - | - | - |
| Outdoor | | | | | | | |
| Rosengarten | 400 m ² | | - | - | - | - | 1.000 € |
| Atrium | 222 m ² | | - | - | - | - | 1.000 € |
| Basement | | | | | | | |
| Sputnik | 127 m ² | 2,80 m | 98 | 39 | - | - | 1.000 € |

Please let us know if renting Cafe Moskau is interesting for you. We would be pleased to draft you an individual offer.

The maximum capacity for each floor is 800 people. The seating numbers are benchmarks and may depend on the concept and set-up. All prices are net prices and are exclusive of VAT. Additionally we charge costs for power, water, staff and cleaning. A 10 Mbit/s network (up- and download-rate of 4 Mbit/s) for internal usage is included. All specifications are subject to change and have to be inspected on-site.

* 50% of the listed price is charged for set-up and dismantling days.

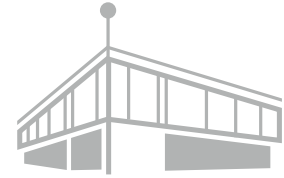

CAFE MOSKAU
BERLIN

FLOOR PLAN

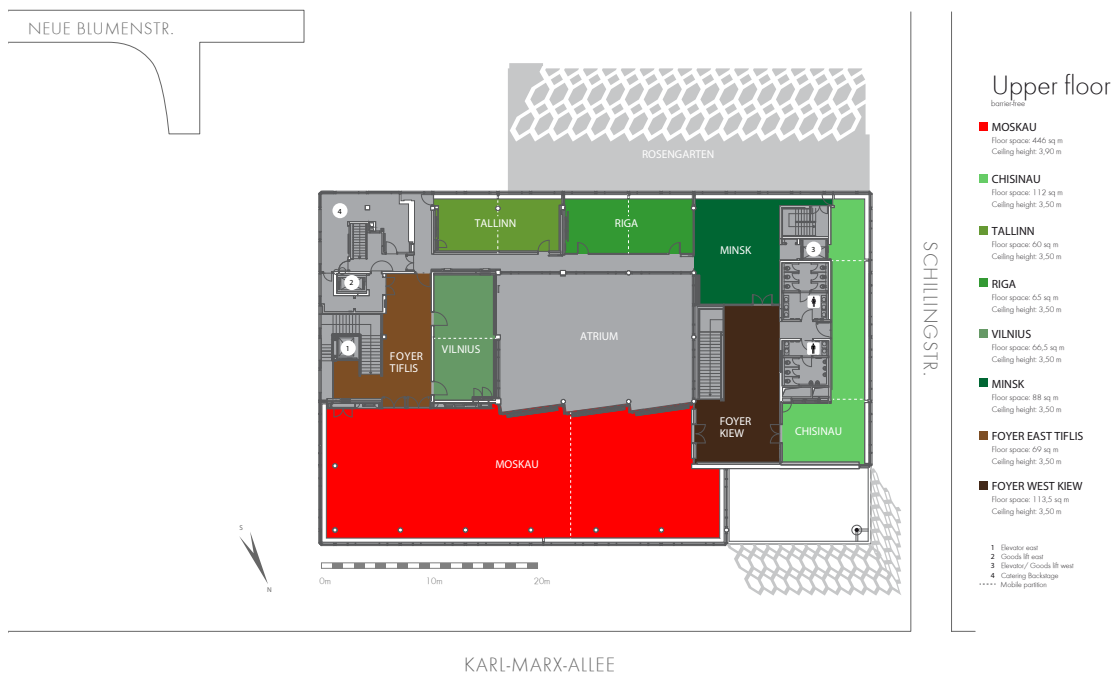

DIVERSE SERVICES



PERSONAL

We have a large network of competent, experienced service providers available to assist you in various areas. Starting from barista to barkeeper up to first aid team, photographer, hosts/hostess or security. We are more than happy to support you with your staff planning.



BEVERAGE PACKAGES

We offer many kinds of beverage packages whether you need a standard conference package, organic beverages or customized cocktails. Each beverage package can be upgraded with coffee specialities. You can choose between an automatic and an italian coffee machine with a barista who will fascinate your guests with artistic Latte Art.

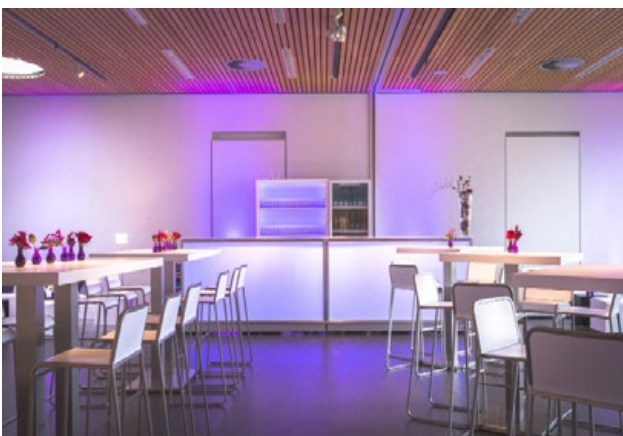

MOBILE BARSYSTEM

Our mobile bar system includes bar elements and shelves with coloured LED lights as well as fridges. All elements can be branded.

DIVERSE SERVICES



BRANDING SPACES

When it comes to branding your event, the exterior facades of Cafe Moskau feature two banner spaces providing room for your personalised banner with high visibility.

Another branding option could be the plotting of the window facade, the mobile bar system or the wardrobe counter.



INTERNET

All event spaces at Cafe Moskau are full Wifi-enabled (bandwidth may be upgraded from 10 Mbit/s to 200 Mbit/s (synchronously)). Let us know your needs and we'll draw up a tailor-made quote. When using the Wifi, you will be given personalised access details in advance.



MARQUEES & CLOAKROOM

We can offer various marquee options to extend function space of Cafe Moskau. Both outdoor areas Atrium and Rosengarten can be covered using marquees. The eastern and western foyer offer enough space for a cloakroom holding up to 500 clothing items.

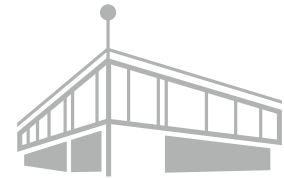

CAFE MOSKAU
BERLIN

CONTACT & PARTNER

LOCATION

Cafe Moskau
Karl-Marx-Allee 34
10178 Berlin

DELIVERIES

Neue Blumenstraße 13

OFFICE

Cafe Moskau GmbH
Milastraße 2
10437 Berlin

ENQUIRIES & VISITS

Sales Team
Fon +49.30.470 807 77
event@cafemoskau.com

EVENT ORGANISATION & QUESTIONS CONCERNING PRODUCTION

Production Team
Fon +49.30.470 809 00
produktion@cafemoskau.com

SECURITY

FSB-Security
Jörn Ullmann
joern.ullmann@fsb-security.com

CATERING

AXICA Catering
Alexandra Beck
Fon +49.30.200 086 640
alexandra.beck@axica.de

Culinary Rebellion
Eventcatering GmbH
Dirk Müller
Fon +49.30.340 441 59
info@kochbox.com

Einhorn Restorations GmbH
Tina Tischendorf
Fon +49.30.343 354 0
tina.tischendorf@einhorn-catering.de

Wild & Wiese GmbH & Co. KG
Ralf Dekorsy
Fon +49.30.657 779 01
ralf.dekorsy@wildundwiese.de

BARCATERING

Barracuda Barcatering
Jens Raasch
Fon +49.162.109 089 9
j.raasch@barracuda-barcatering.de

FURNITURE & DECORATION

Party Rent Berlin
Katharina Riedesel
Fon +49.30.200 061 513 7
katharina.riedesel@partyrent.com

LIGHT & SOUND

AMBION GmbH
Mathias Kaminski
Fon +49.30.726 278 412 3
cafemoskau@ambion.de

EVENTMANAGEMENT

BEYOND-events
Jeannette Bangura
Fon +49.30.810 960 96
jbangura@beyond-events.de

HOTEL

Hotel Amano Grand Central
Julia Herchenbach
Fon +49.30.400 300 210 1
Heidestraße 62, 10557 Berlin
herchenbach@amanogroup.com

Hotel Amano
Julia Herchenbach
Fon +49.30.400 300 210 1
Auguststraße 43, 10119 Berlin
herchenbach@amanogroup.com

DRIVER SERVICE

BerlinMobil Frank Richert GmbH
Doreen Plischkaner
Fon +49.30.422 199 14
plischkaner@berlinmobil.de

LOCATION & ARRIVAL

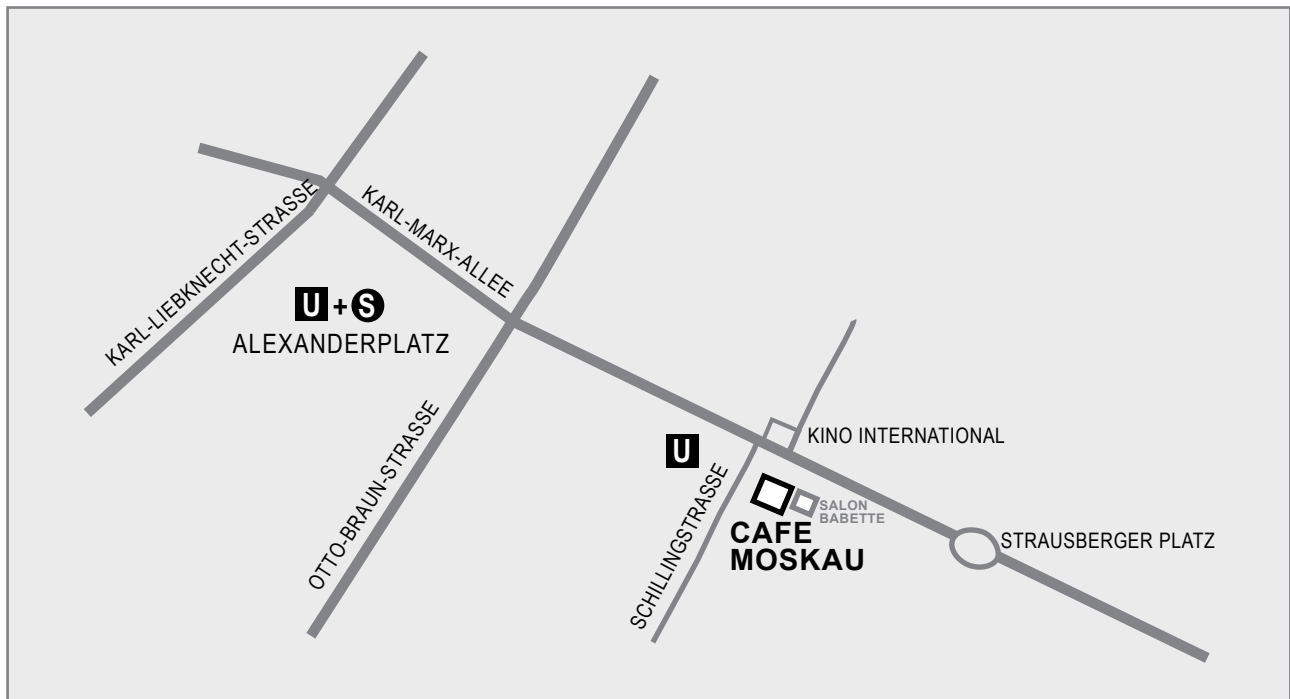

Cafe Moskau is located in Berlin-Mitte, a five minute walk from Alexanderplatz and directly in front of underground station Schillingstraße.

PUBLIC TRANSPORTATION

From Alexanderplatz: underground line U5 to Schillingstraße

From Hauptbahnhof (main station): S-Bahn S3, S5, S7 or S9 to Alexanderplatz, further with underground line U5 to Schillingstraße

From airport TXL: Bus TXL to Hauptbahnhof (main station), S-Bahn S3, S5, S7 or S9 to Alexanderplatz, further with underground line U5 to Schillingstraße

From airport SXF: Taxi ca. 45 Minuten

PARKING

There is sufficient public parking available.