



TICKET B

Experience architecture.

TOUR PROGRAMME 2019

TICKET B - experience architecture
Thomas Michael Krüger · Architekt BDA
Frankfurter Tor 1, 10243 Berlin
Fon +49(0)30 420269620, Fax +49(0)30 420269629
Mail: info@ticket-b.de, Internet: www.ticket-b.de
Network: www.guiding-architects.net

Index

TICKET B – Experience architecture	3
Overview of our Tours	4
Classic Tours	
Parliamentary District	5
The New Museum Island	6
A cut through the inner city	7
Central East / City West	8
Karl-Marx-Allee / Hansaviertel	9
Europacity	10
Extra Tours	
Berlin Overview	11
Embassies and State Representations	12
20ies Berlin	13
Modernist Housing Estates	14
Science and Research	15
Contemporary residential buildings n° 1 - Prenzlauer Berg	16
Contemporary residential buildings n° 2 - Kreuzberg	17
Green City - Berlins open spaces by bike	18
Boat cruises	19
The new Potsdam	20
Premium Tours	21
Interior Visits	22
SideSteps	23
Events/Conferences/Presentations/Trips	24
Publications	25
Selection of References 1996–2018	26
What our clients say ...	27



© Marnie Schäfer



TICKET B – Experience architecture

Our highly qualified team of graduated architects, professors, lecturers and specialist authors present you with an exciting and authentic insight into the development of contemporary architecture in Berlin. Apart from looking at current construction projects and technology, the tours also focus on historical and social aspects. Years of experience and a far-reaching network of specialists enable us to offer you exclusive access to sites and buildings usually not open to the public. Our clients have been enjoying unique insights into the many facets of Berlin's exciting metropolis since 1996.

All tours have been designed for groups and are either conducted as walkabout tours, or on bicycle, bus or boat. They are offered in the following languages (at no extra cost): German, English, French, Spanish and Italian.

Thomas Michael Krüger is the founder and CEO of Ticket B. He is an architect (BDA) and university teacher. He works with a team of currently 15 specialist colleagues who contribute their many years of experience to the tours - either as journalists, as architects directly involved in contemporary construction projects, or as teachers at universities in Germany or abroad. Well-versed in the presentation of architecture and urbanism Ticket B has guided over 100.000 enthusiastic visitors. Ticket B also works on developing concepts for the representation of building culture, organizes events and lectures and mediates professional presentations.

Starting in 2000 architectural and artistic journeys have become a further part of our core business. Our annual journeys to Japan and visits of the Art and Architecture Biennale in Venice are an example of these successful formats.



Overview of our Tours

The architectural tours on offer span from 1.5 hour interior visits to excursions lasting several days. They are generally designed for groups, but also suitable for individuals. All tours are arranged by individual appointment. For larger groups (more than 25 participants) we offer a professional communication system with headphones.

Classic Tours (see p.5)

Classic-Tours are our basic format, using predefined topics and routes. The duration of these half-day walkabout tours varies between 2 to 4 hours.
Half-day tours cost € 490, full-day tours cost € 890.

Extra Tours (see p.10)

These tours are modified Classic Tours that can be adapted to customer requirements i.e. with a meeting place of your choice or bus transfers to and from the train station or airport.
Half-day tours cost € 690, full-day tours cost € 1.240.

Premium Tours (see p.20)

The essence of our Premium-Tours are customized programs that are designed to the individual wishes of the customer. Specific architectural topics such as residential housing, sustainability, urban development or landscaping, an exclusive service with special arrangements and participation of external experts characterize these formats.
Half-day tours cost € 890, full-day tours cost € 1.690.

Interior visits to individual buildings (see p.21)

We provide exclusive access to places and buildings not generally open to the public and explain relevant aspects of architectural history, architectural concepts, as well as the background of the building process. These extensive interior visits can be combined with all other tours. They cost € 300.

All prices refer to a group with up to 25 participants plus 19% VAT and additional tour-specific expenses like entrance fees and transport etc. We gladly also organize hotels, restaurants and tickets for public transport for a service fee starting at € 50.



CLASSIC TOUR

Parliamentary District

This tour explains the parliamentary buildings and landscaping around the Reichstag and Federal Chancellery. Set out along the linear composition of the so-called 'Band des Bundes', the parliamentary buildings connect the formerly divided sides of the river Spree, elegantly demonstrating the new face of Berlin's political power.

Buildings visited in the course of the tour – including interior visits:

Parliamentary District

Reichstag (Lord Norman Foster), Federal Chancellery and Bundestag underground station (Schultes Frank), Forum (Lützow 7), Paul-Löbe-Haus and Marie-Elisabeth-Lüders-Haus (Stefan Braunfels), Swiss Embassy (Diener und Diener), Spreebogen Park (w+s), Kronprinzen bridge (Santiago Calatrava), Kindergarden (Gustav Pechl)

Additionally you can choose between 2 options:

a) Focus Hauptbahnhof (main train station, gmp)

A new urban district is developing around the transparent new main train station located at the heart of the capital: Cube (3XN), office and residential building (Hadi Teherani), Hotel Barceló and office building (Bolwin Wulf) - all under construction

b) Focus Pariser Platz:

'Critical reconstruction' surrounding the Brandenburg Gate, Academy of the Arts (Günter Behnisch and Werner Durth), DZ Bank (Frank Gehry), French Embassy (Christian de Portzamparc), Allianz Forum (gmp), Brandenburger Tor underground station (Hentschel Oestreich / Artus), Holocaust Memorial (Peter Eisenman)

Duration approximately 2.5 hours

€ 490 (plus 19% VAT) for a group with up to 25 participants, excl. additional costs for entrance fees, transport etc.



© Stiftung Preußischer Kulturbesitz



© Büro David Chipperfield



© Stiftung Preußischer Kulturbesitz

CLASSIC TOUR

The new Museum Island

The restoration of the Museum Island according to David Chipperfield's master plan is Berlin's largest inner city project since the completion of Potsdamer Platz. Following the celebrated re-opening of the New Museum, the construction of a new central entrance building, the James Simon Gallery, marks the completion of the UNESCO World Heritage site's extensive restoration – leading to an impressive 21st century museum complex. Buildings visited in the course of the tour – including interior visits:

Lustgarten

Altes Museum (Karl Friedrich Schinkel, Hilmer & Sattler und Albrecht), Lustgarten (Karl Friedrich Schinkel, Hans Loidl), Berliner Dom (Julius Carl Raschdorff)

Museum Island

Alte Nationalgalerie (Friedrich August Stüler, Heinrich Strack, H.G. Merz), Colonnade Courtyard (Levin Monsigny), Bode Museum (Ernst von Ihne, Heinz Tesar), Pergamon Museum (Alfred Messel, Ludwig Hoffmann, O. M. Ungers, Jan Kleihues, Walter Noebel), Galerie am Kupfergraben and the construction site of the James Simon Gallery (David Chipperfield)

New Museum

The highlight of this tour is a guided visit of the New Museum (Friedrich August Stüler) renovated by David Chipperfield and Julian Harrap - one of the most important museum conversions in recent years, lauded with many architectural awards.

Duration approx. 2.5 hours

€ 490 + € 35 for a group tour licence + € 10 admission price per person

All prices are plus 19% VAT and for a group with up to 25 participants



CLASSIC TOUR

A cut through the inner city

Cutting through the city along Friedrichstraße, our walk begins at one of the most famous urban buildings of classic modernism, the IG Metall house by Erich Mendelsohn dating from 1927. The area of southern Friedrichstadt, being the central area of the Internationale Bauausstellung in the years 1984-87, was a place of pilgrimage for architects in the 80s. 30+ years later, new things come into being: a self-determined place to live and work near the former central flower market and the new media campus of the Axel Springer publishing house at Checkpoint Charlie. The tour ends with the lighthouse projects in the historical heart of Berlin's center: the construction sites of the Humboldt Forum (former city palace) and the new entrance building to the Museum Island.

Walk along Friedrichstraße

IG Metall house (Erich Mendelsohn), Jewish Museum and Academy (Daniel Libeskind)
 Live & Work at Blumenmarkt, IBA 1984-87 - residential projects (Kollhoff&Ovaska, Arata Isozaki, Hermann Hertzberger), GSW highrise building (sauerbruch hutton), Axel-Springer-Campus (Rem Koolhaas, OMA), Gendarmenmarkt, Schlossplatz with Berliner Dom (Julius Carl Raschdorff), Colonnade Courtyard (Levin Monsigny), New Museum (Friedrich August Stüler, David Chipperfield), James Simon Gallery - new entrance building (David Chipperfield)

Duration approximately 2.5 hours

€ 490 (plus 19% VAT) for a group with up to 25 participants, excl. additional costs for entrance fees, transport etc.

Bookable as a walkabout tour or as an extended bike tour including a visit of Berlin's official city model, (plus € 20 pp bike rental)



CLASSIC TOUR

Central East / City West

Berlin has two main city centers:

The GDR created an expansive, large-scale public space surrounding the iconic TV tower at Alexanderplatz that was supposed to radiate international modernity.

Meanwhile in the West the commercial center of the walled city asserted itself near the Kaiser Wilhelm Memorial Church, including the Europa Center near to Zoo Station.

Today buildings on both sides call for modernization. In the East as well as in the West new skyscrapers are being built. Nevertheless there are great differences: While Alexanderplatz boasts new apartment buildings and a shopping center, the result of the revitalization in the west are new concept mall and entertainment mile including the Bikini building and Zoopalast cinema.

Buildings visited in the course of the tour – including interior visits:

Central East

House of the Teacher and Convention Centre (BCC, Hermann Hensemann), Alexanderplatz and TV Tower, House of Travel, House of the Press, Rathauspassagen residential building (Heinz Graffunder), Red Town Hall, Humboldt Forum (reconstruction of the City Palace) Staatsratsgebäude

City West

Bikini Berlin and Zoopalast (SAQ, Hild and K, mask and Suhren), Kaiser Wilhelm Memorial Church (Egon Eiermann), Ludwig-Erhard-Haus (Nicolas Grimshaw), Upper West (Langhof architects), Waldorf Astoria Hotel (Christoph Mackler) and Neues Kranzler Eck (Helmut Jahn)

€ 490 (plus 19% VAT) for a tour of Central East **or** City West, duration approx. 2.5 hours

€ 850 (plus 19% VAT) for both, duration approx. 6 hours

for groups with up to 25 participants, excl. additional costs for entrance fees, transport etc.



© Britta Krehl



© Britta Krehl



CLASSIC TOUR

Karl-Marx-Allee / Hansaviertel

These two major urban layouts of the postwar period are candidates for UNESCO World Heritage status. They represent different political systems and show postwar housing in a variety of ways at its highest level.

While the representative facades and floor plans of the former Stalin Allee follow the concept of 'National Tradition', the buildings of the 'Interbau 1957' are experimental and innovative. The eastern monumental avenue with its 'sugarbaker'-style was supposed to make palaces available to the working class of the young GDR while the western Hansa district celebrated the revival of international modernism, designed by more than 50 renowned architects.

Buildings visited in the course of the tour – including interior visits:

Karl-Marx-Allee

Skyscraper at Weberwiese with rooftop conservatory (Hermann Hensemann), Cafe Sybille, apartment at Frankfurter Tor, Galerie Central Berlin on Straußberger Platz

New architecture: Pablo Neruda Library (Peter W. Schmidt), residential complex on Rigaer Straße (zanderroth architects)

Interbau 1957 - Hansa district

Residential buildings (Oscar Niemeyer, Walter Gropius, Arne Jacobsen, Sep Ruf, Alvar Aalto, van den Broek and Bakema, Egon Eiermann and many others), Eternit House, Giraffe House, Hansa Library, Academy of the Arts Hanseatenweg (Werner Düttmann), Berlin Pavilion

Interbau 1957 - Corbusier House (including visit of an apartment)

€ 490 (plus 19% VAT) for Karl-Marx-Allee or Hansaviertel, duration approx. 2.5 hours

€ 850 (plus 19% VAT) for both, duration approx. 6 hours

for groups with up to 25 participants, excl. additional costs for entrance fees etc.



CLASSIC TOUR

Europacity

To the north of Berlin's main station and in direct proximity to the Parliamentary District a new urban quarter is emerging on an area of 40 hectares. Residential, office and retail usages create the typical 'Berlin Mix' and the urban development is set to be exemplary in terms of sustainability and ecology. The Tour Total highrise was first to go up in 2012, followed by the 50 Hertz headquarters (DGNB diamond certificate) and the Art Campus. Various housing projects are currently under construction and the competition for a highrise building on Europaplatz was concluded in June 2017.

Promenade from main station to Invalids' cemetery

main station (gmp), Cube (3XN), Tour Total & Monnet 4 (Barkow Leibinger), 50 Hertz headquarters (Love Architecture), Flick Collection (Kühn Malvezzi), Ernst Basler AG office building (Miller Maranta), residential building and gallery (Leon Wohlhage Wernik), riverside promenade (relais), Hamburger Bahnhof (Friedrich Neuhaus, J.P. Kleihues), Berlin Wall Trail, Invalids' cemetery, southern city port district (various architects)

Additionally you can choose between 2 options:

a) Focus Lehrter Straße

Walk along Lehrter Straße via: history park on the grounds of the former Moabit prison (glaßer und dagenbach), Botschaft der Kinder (Ludloff&Ludloff), Mittenmang residential project (various architects)

b) Focus Kapelle-Ufer

Walking tour of the new developments along the river Spree: Humboldthafen Eins (KSP Jürgen Engel), Futurium (Richter Musikowski), Federal Press Conference (Nalbach+Nalbach), Heinrich Böll Foundation (e2), Boros collection (realarchitektur)

Duration approximately 2.5 hours

€ 490 (plus 19% VAT) for a group with up to 25 participants, excl. additional costs for entrance fees, transport etc.

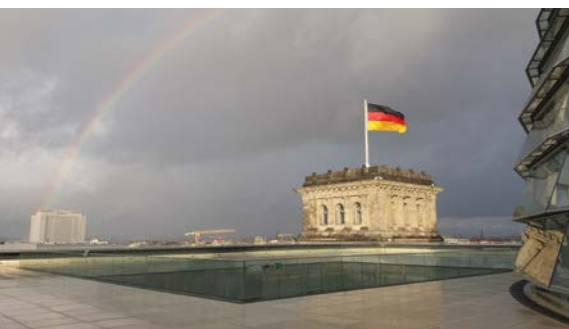

EXTRA TOUR

Berlin Overview

With its ever-changing history and decentralized structure, Berlin is a vast and diverse city. This tour includes the two centers in the East and West, giving a comprehensive insight into the many facets of the city.

City model

The tour starts with explanations of Berlin's official city model and a subsequent walk to the Museum Island.

Bus tour

The second part of the tour is done by bus: drive to City West, via Hansa district, Potsdamer Platz, Friedrichstraße, Alexanderplatz, Media City Spree, East Side Gallery, Karl-Marx-Allee and Berlin's typical workers' housing districts Prenzlauer Berg and Kreuzberg.

Promenade through the Parliamentary District

The journey ends with a stroll through the parliamentary district to the main train station and a ride on the shortest German subway route past newly designed subway stations to the Brandenburg Gate. The tour ends at the Academy of the Arts and the adjacent Holocaust Memorial.

Day tour, duration approx. 8 h

€ 1.240 (plus 19% VAT) for a group of up to 25 persons

excl. admissions and approximately 280 € for 2h bus rental (plus 19% VAT)

Viable also as a half day tour (in excerpts), duration approx. 3-4 hours

€ 690 (plus 19% VAT) for a group of up to 25 person

excl. admissions and approximately 185 € for 1h bus rental (plus 19% VAT)



© Andreas Muhs

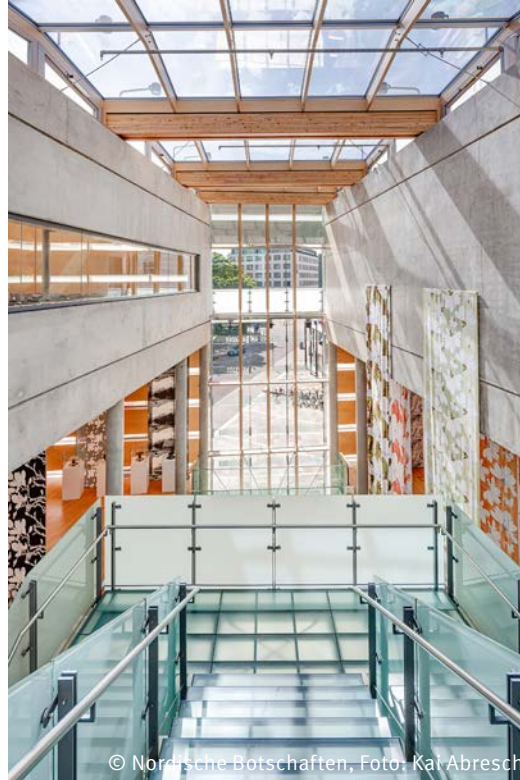

© Nordische Botschaften, Foto: Kai Abresch



© Nordische Botschaften, Foto: Kai Abresch

EXTRA TOUR

Embassies and State Representations

The return of embassies to the diplomatic quarter in the Tiergarten district has brought forth an array of modern buildings and ambitious architectural concepts, as well as the restoration of a number of historical and monumental buildings from the Nazi era. The tour illustrates the vibrant diversity of architectural materials and structures with which the various countries and states express their local traditions.

Buildings visited in the course of the tour – including interior visits:

Embassies

Nordic Embassies (Berger + Parkkinen, 3xN, Pálmar Kristmundsson, Snøhetta, Viiva arkkitehtuuri Oy, Gert Wingårdh, Pysall Ruge), Embassies of Japan and Italy, Greece, the Slovak Republic and Estonia as well as Mexico (Gonzales/Léon), Austria (Hans Hollein), India (LéonWohlhageWernik), South Africa (MMS Architekten) and Turkey (Nickol Schmidt Hillig)

State representations

Bremen (LéonWohlhageWernik), North Rhine-Westphalia (Petzinka, Pink und Partner), Baden-Württemberg (Dietrich Bangert), Konrad Adenauer Foundation (Thomas van den Valentien), Bundeswehr (German Armed Forces) Memorial (meck architects), Diplomats' Park (Florian Fischötter, Frank Schiffer, Klaus Theo Brenner, Haas)

Duration approx. 3 hours

€ 690 (plus 19% VAT) for a group with up to 25 participants, excl. additional costs for entrance fees, transport etc.

can be combined with the Classic Tour ‚City West‘



EXTRA TOUR

20ies Berlin

The Bauhaus is known all over the world and is regarded as the most influential schools of the 20th century in the field of architecture, art and design. In addition to buildings by well-known Bauhausers such as Hannes Meyer and Ludwig Mies van der Rohe, Berlin also features buildings by Mendelsohn and Taut, showing a more complex picture of classical modernism. In the twenties a lesser known, broad spectrum of significant buildings of classical modernism emerged, with curved forms and expressionist colors.

The Northwest - From Expressionism to Unité

Haus am Rupenhorn (Wassili and Hans Luckhardt with Alfons Anker), Haus des Rundfunks (Hans Poelzig), Großsiedlung Siemensstadt (Ringsiedlung, u. a. Hans Scharoun, Walter Gropius, Fred Forbat, Hugo Häring), Unité d'Habitation (1957, Le Corbusier)

The Southeast - From large urban projects to rural settlements

IG-Metall-Haus (Erich Mendelsohn), Haus der Buchdrucker (Max Taut), Ullstein Druckhaus (Eugen G. Schmolh), Tempelhof Airport, Hufeisensiedlung (Bruno Taut)

Half day tour northwest **or** southeast, duration approx. 3-4 hours each
 € 690 (plus 19% VAT) for a group of up to 25 persons
 excl. admissions and approximately 460€ for 4h bus rental (plus 19% VAT)

combined as a day tour, duration approx. 8 h
 € 1.240 (plus 19% VAT) for a group of up to 25 persons
 excl. admissions and approximately 840 € for 8h bus rental (plus 19% VAT)



© Anja Steinmann



© HR Meissner



EXTRA TOUR

Modernist Housing Estates

The idea of new, modern, light-flooded dwellings were implemented in a unique form during the Berliner interwar period. In the 1920s, the six green settlements were developed as a counter-project to the hitherto dominant tenant buildings of the Berlin workers' families. In 2008 they were registered in the UNESCO World Heritage List because of their social aspirations and their outstanding importance for 20th century urban planning and architecture.

All six settlements are visited as part of a full-day bus tour - being the operator of two information stations in the Hufeisen-Britz and Siemensstadt settlements, Ticket B offers exclusive access to shops and apartments.

Housing Estates North Berlin

Großsiedlung Siemensstadt - „Ringsiedlung“ - (Hans Scharoun, Walter Gropius, Otto Bartning, Hugo Häring, Fred Forbat und Paul-Rudolf Henning); Siedlung Afrikanische Straße (Mies van der Rohe); Siedlung Schillerpark (Bruno Taut); Weiße Stadt (Otto Rudolf Salvisberg, Bruno Ahrends und Wilhelm Büning) and Carl-Legien-Siedlung (Bruno Taut) in Prenzlauer Berg

Housing Estates South Berlin

Hufeisensiedlung Britz and „Tuschkastensiedlung“ Falkenberg (Bruno Taut) or alternatively Onkel-Tom-Siedlung (Bruno Taut, Otto Rudolf Salvisberg und Hugo Häring), Waldsiedlung Quermatenweg

Day tour, duration approx. 8 h

€ 1.240 (plus 19% VAT) for a group of up to 25 persons

excl. admissions and approximately 840 € for 8h bus rental (plus 19% VAT)

Viable also as a half day tour, with bus or public transport, duration approx. 3-4 hours

€ 690 (plus 19% VAT) for a group of up to 25 persons

excl. admissions and approximately 460 € for 4h bus rental (plus 19% VAT)



© Florian Bolk

EXTRA TOUR

Science and Research

Berlin is not only a cultural metropolis known for its young and active party, fashion, film, music and more recently food scene, but has also established a firm hold in the international ranking of science and research hubs.

About 200.000 people from all over the world study, teach and do research at four universities, four art schools, seven technical colleges and numerous private institutions. Technology parks, laboratories, research centers and business incubators are constantly enriching the scientific landscape with new buildings. In addition to highly specialized research buildings the numerous libraries and university faculties play a major role in contemporary architecture. New campus libraries at the Freie Universität or the growing faculties at the Humboldt Universität in the successful Adlershof science park produce innovative buildings and call for architectural expeditions into the world of laboratories, lecture halls and media centres.

Adlershof science park

Faculty of Physics at the Humboldt Universität (Augustin und Frank), Center for Photonics and Optical Technologies (Sauerbruch Hutton), Adlershof student village (die Zusammenarbeiter), windchannel, Erwin Schrödinger Zentrum (Gössler Kinz Kerber Kreienbaum), campus housing (various architects)

Campus Freie Universität

Henry Ford building (Gustav Müller, Franz Heinrich Sobotka), Silver- and Rustpavilion (Georges Candilis, Alexis Josic, Shadrach Woods und Manfred Schiedhelm, Sanierung Norman Foster), ‚The Brain‘ Philological Library of the Freie Universität (Norman Foster), Woodpavilion (Florian Nagler)

Halfday-tour of Adlershof or Freie Universität, duration approx. 3-4h, 690€ (plus 19% VAT)
combined day-tour of both, duration approx. 8h, 1.240€ (plus 19% VAT)
for a group of up to 25 people, excl. admissions and transport



© Berndt Borchardt



© Simon Menges



© Graft



© Simon Menges

EXTRA TOUR

Contemporary residential buildings n° 1 - Prenzlauer Berg

After years of stagnation, social housing is once again on the rise in Berlin. Among the first to successfully create affordable housing were so called „Baugruppen“, private building initiatives that have brought forward innovative architecture.

Today housing cooperatives and investment companies alike are reviving Berlin's history of innovative housing.

This tour leads you to selected projects in the district of Prenzlauer Berg. It can be done by public transport, by bike or by bus. We can organize interior visits in selected buildings upon request.

Berlin Wall Memorial - Bernauer Straße

Park (Sinai), Chapel of Reconciliation (Reitermann u. Sassenroth), Townhouses at Bernauer Straße (various architects), Residential building Strelitzer Straße (Fat Koehl), Residential building Schönholzer Straße (roedig schop), Residential building Sc11, Residential building Ru43 (Zanderroth), Marthas Hof (Grüntuch Ernst)

Winsviertel - Bötzowviertel

Paragon Apartments (Graft), family centre Christburger Str. 13 (Kaden Klingbeil), Residential building Cb 19 (Zanderroth), Residential building E3 (Kaden Klingbeil), Big Yard Zelterstraße (Zanderroth), Townhouses Prenzlauer Gärten (Stephan Höhne)

Halfday-tour of selected projects, duration approx. 3-4h, 690€ (plus 19% VAT)

day-tour, duration approx. 8h, 1.240€ (plus 19% VAT)

for a group of up to 25 people

on request: 150€ (plus 19% VAT) per interior visit

20€ (plus 19% VAT) per person and day for bike rental **or**

460€/840€ (plus 19% VAT) for 4h/8h bus rental

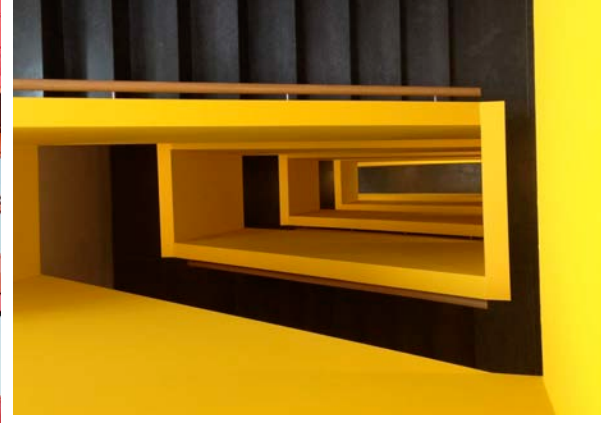

EXTRA TOUR

Contemporary residential buildings n° 2 - Kreuzberg

Berlin is growing. In times of housing shortages and rising rents, community housing projects are becoming increasingly important. „Baugruppen“ initiatives hold aesthetics and ecology higher than profit maximisation. The result is varied and innovative architecture in which sustainability and community play an important role.

This tour leads you to selected projects in the district of Kreuzberg. It can be done by public transport, by bike or by bus. We can organize interior visits in selected buildings upon request.

Gleisdreieck Park

Flottwell Zwei (Winfried Härtel / Tim Heide / Verena von Beckerath), Flottwellstr. 9-12 (Veauthier Meyer), Dennewitz eins (roedig schop), Gleisdreieck Park (Atelier Loidl), Lokdepot (robertneun)

Friesenstraße quarter

THF, Columbia studios (Blaufisch), 7up (Anne Lampen), Barceloneta (Blase & Kapici, Artis company building (Ziegert Roswag Seiler)

Engelbecken and former central flower market

Engeldamm 60, Dresdener Str. 31 (HKA Hastrich Keuthage), Luisenstädtischer Kanal (Christa Ringkamp), Prinzessinnengärten (Nomadisch Grün), R50 (ifau, Jesko Fezer und Heide & von Beckerath), IBeB – integrative building project at the former central flower market (under construction - ifau, Heide & von Beckerath)

Halfday-tour of selected projects, duration approx. 3-4h, 690€ (plus 19% VAT)

day-tour, duration approx. 8h, 1.240€ (plus 19% VAT)

for a group of up to 25 people

on request: 150€ (plus 19% VAT) per interior visit

20€ (plus 19% VAT) per person and day for bike rental **or**

460€/840€ (plus 19% VAT) for 4h/8h bus



EXTRA TOUR

Green City

Berlin's open spaces by bike

To experience architecture, urban development and landscape design by bike is a special adventure in Berlin. Your radius of action is much larger and you can take in more of the city.

Particularly open spaces, such as the award-winning, ground-breaking landscape design project Gleisdreieck Park or the expanse of the abandoned Tempelhof airfield are experienced in their entire dimensions.

In cooperation with a bike rental station we offer group tours starting in Berlin-Mitte or at an extra charge from any other location in Berlin. In general all tour formats are bookable as bike tours. The following tour is particularly suitable for cycling:

Open spaces - from the central station to the Tempelhof airfield

Hauptbahnhof (gmp), Spreepromenade (Kienast + Vogt), Prison Park on Invalidenstrasse (Glaßer + Dagenbach), Spreebogenpark (Weber + Saurer), Swiss Embassy (Diener+Diener), Band des Bundes and Bundeskanzleramt (Schultes + Frank), Reichstag (Refurbishment: Sir Norman Foster), Platz der Republik (Lützwow 7), Holocaust Memorial (Peter Eisenman), Potsdamer Platz quarter, Tilla-Durieux-Park (ds), Sony-Center (Helmut Jahn, Peter Walker), Gleisdreieck Park (Atelier Loidl), Tempelhof airfield

Day tour, duration approx. 8 h

€ 1.240 (plus 19% VAT) for a group of up to 25 persons

plus 20€ (plus 19% VAT) per person and day for bike rental

In excerpts also viable as a half day tour, duration approx. 3-4 hours

€ 690 (plus 19% VAT) for a group of up to 25 persons

plus 20€ (plus 19% VAT) per person and day for bike rental



EXTRA TOUR

Boat cruises

Experience Berlin by water!

We offer historic ships through our partner Schiffskontor or open-top water taxis.

Our possibilities range from one-hour short tours to the center of Berlin including the Museum Island, the Parliamentary District and main station to 3-hour sight seeing programmes along the river Spree and the Landwehrkanal through Charlottenburg and Kreuzberg, past Potsdamer Platz, Osthafen and the Media City Spree - including on-board catering upon request.

The tours are individually tailored to your needs, group size and time frame. The following is a proposal for a short tour:

1h round trip from/to Museum Island

Sluice at the Mühlendamm bridge, Humboldt Forum construction site, Berlin Cathedral
Museum Island: Bode Museum, Pergamonmuseum, Old National Gallery
The Parliamentary District on the banks of the river Spree: the Reichstag Building (Lord Norman Foster), Paul-Löbe-Haus/Marie-Elisabeth-Lüders-Haus (Stephan Braunfels), Kronprinzen bridge (Santiago Calatrava), Chancellery (Schultes Frank), Main station (Gerkan, Marg and Partner), Humboldthafen, Europacity construction site (various architects), Bellevue Castle, Bundesschlange (Georg Bumiller)

Round trip by boat, duration approx. 1 hour
€ 990 (plus 19% VAT) for a group of up to 25 persons

Prices for longer tours, larger groups and other itineraries on request



EXTRA TOUR

The new Potsdam

Until now the architectural legacy of Karl Friedrich Schinkel and landscape design by Peter Joseph Lenné shaped the image of Potsdam. But already as far back as 1924 an icon of modern architecture was added to the so-called ‚smiling classicism‘ with its castles and follies: the Einstein Tower by Erich Mendelsohn. Today among other projects the reconstruction of the Potsdamer Castle, the new seat of the Brandenburg Landtag, re-defines the current Potsdam as a confident, growing city.

Buildings visited in the course of the tour – including interior visits:

Neoclassical buildings and parks

Palace and Park Sanssouci (Frederick the 2nd and Georg Wenceslaus von Knobelsdorff); Roman Baths and Charlottenhof Palace (Karl Friedrich Schinkel, Ludwig Persius and Peter Joseph Lenné); Palace and Park Klein-Glienicke

Einstein Tower (Erich Mendelsohn)

Contemporary Potsdam

Hans Otto Theatre (Gottfried Böhm); Federal Foundation for Building Culture (Springer architects); Indoor swimming pool on Brauhausberg (under construction, gmp); Castle / Brandenburg Landtag (Peter Kulka); Palais Barberini (Carl von Gontard, Thomas Albrecht / Hilmer & Sattler)

Day tour, duration approx. 8 h

€ 1.240 (plus 19% VAT) for a group of up to 25 persons

excl. admissions and approximately 280 € for 2h bus-rental (plus 19% VAT)

Viable also as a half day tour (in excerpts), duration approx. 3-4 hours

€ 690 (plus 19% VAT) for a group of up to 25 person

excl. admissions and approximately 185 € for 1h bus rental (plus 19% VAT)



PREMIUM TOURS

Example: Sustainable Building

Originally used in forestry, the concept of ‚sustainability‘ saw its revival with the World Climate Conference of Rio de Janeiro in 1992 - ‚sustainable development‘ became a global policy task and the guiding principle for human action. Sustainable planning and building requires equal consideration of ecological, economic and social issues. In addition it requires the consideration of the individual building project in its urban context.

As architects in practice we offer tailor made tours with exclusive insights, call in experts and organize interior visits.

From the vast choice of buildings scattered all over the city we will boil down and organize a tour that takes into account your specific interests and meets your requirements for well-founded information. Here are just a few sample topics:

Urban timber construction

3xgrün (Institut für Urbanen Holzbau), building site Pistoriusplatz (Kaden+Lager), Christburger Str. / E3 (Kaden Klingbeil), Waldorfcampus (Kersten+Kopp)

Sustainable concepts

Flussbad Berlin (realities:united), Holzmarkt (various architects), Spreefeld (FATKoehl, carpaneto schoeningh, BAR), Spree 2011 (Ralf Steeg), Rainwater management at Potsdamer Platz (Atelier Dreiseitl), Adlershof science park (various architects)

Special arrangements for the framework programme, bus-rental and reservations of restaurants etc. can also be organized on request

Viable as a half-day or day tour
starting from € 890 (plus 19% VAT) for a group of up to 25 people,
excl. admissions and transport



© Jan Bitter



© Stefan Müller



Interior Visits

Our contacts and contractual arrangements allow us to organize exclusive visits of generally inaccessible buildings, such as:

Jacob and Wilhelm Grimm Center (Max Dudler)

New Museum (restoration by David Chipperfield and Julian Harrap)

Academy of the Arts on Pariser Platz (Günter Behnisch and Werner Durth) and at Hanseatenweg (Werner Düttmann)

Philological Library ‚The Brain‘ (Norman Foster) + Woodpavilion Florian Nagler

Baumschulenweg Crematorium (Schultes Frank)

Jewish Museum (Daniel Libeskind)

Velodrome and Swimming Hall (Dominique Perrault)

Residential high rise building (Hans Scharoun) with visit of his attic studio apartment

Tautes Heim, originally refurbished detached house by Bruno Taut in the Hufeisensiedlung

Corbusier House (Le Corbusier), with apartment visit

Rewe-Green-Building, Rudow/Teltow

Heinrich-Böll-Stiftung, (e2a)

Ministry of the Environment (Jürgen Pleuser)

Duration approx 1.5 hours,
also suitable as a complement to other tours

€ 300 (plus 19% VAT) for a group of up to 25 people excl. charges for admissions, fees, transfer etc.



EXCURSIONS TO THE SURROUNDINGS

SideSteps

We also organize day trips and excursions in the surroundings of Berlin. These tours are individually tailored to your needs, group size and your time frame. Following are some tour suggestions:

Bernau / Eberswalde

Villa Lemke (Mies van der Rohe), Bundesschule Bernau (Hannes Meyer/Hans Wittwer), library of the University of Sustainable Development Eberswalde (Herzog & de Meuron)

Szczecin

New construction of the Philharmonic (Estudio Barozzi Veiga), Przelomy Dialogue Center (KWK Promes – Robert Konieczny), Nowy Rynek, Rynek Sienny, Bulwar Piastowski, Waly Chrobrego

Leipzig

Main station Leipzig (refurbishment HPP), university high rise building (Hermann Henselmann), Paulinum (Erik van Egerat), St. Trinitatis (Schulz & Schulz), Nikolai and Thomas churches, Museum of Fine Arts „Bildermuseum“ (Hufnagel, Pütz, Raffaelian), Leipzig Zoo ‚Zoo of the future‘ : New tropical garden hall Gondwanaland (Henchion Reuter / Ariane Röntz)

Dessau

Bauhaus building (Walter Gropius), master houses (László Moholy-Nagy, Lyonel Feininger, Georg Muche, Oskar Schlemmer, Wassily Kandinsky, Paul Klee), directors‘ house (Walter Gropius, Bruno Fioretti Marquez Architekten), employment agency (Walter Gropius), Dessau-Törten settlement (Walter Gropius), Environmental Bureau (Sauerbruch Hutton)

Day tour, duration approx. 8 h

€ 1.240 (plus 19% VAT) for a group of up to 25 persons

excl. admissions and approximately € 840 for 8h bus-rental (plus 19% VAT)



Events / Presentations / Lectures / Travels

Ticket B continues on the path of promoting architectural experience and expands its activity to the design and implementation events, presentations and lectures.

A media presentation showing current architectural and urban development in Berlin can be an opener for a guided visit, i.e. held the night before or as a starter in the morning at selected locations or at your hotel.

In addition to our core business of tailor-made architectural tours we organize thematic events and symposia in cooperation with selected partners from the building industry. In 2016 Ticket B organized and premiered a series of symposia called „pARCour“ about „Schools - educational institutions in transition“.

Furthermore we organize architectural trips in cooperation with our network partners, Guiding Architects, from Hamburg and Munich. In 2018 we offer trips to Japan, Poland and Israel.

As of summer 2017 Ticket B is commissioned with the organization and coordination of Berlin's architectural advisory board, the Baukollegium.

For up-to-date information about all Ticket B activities please subscribe to our newsletter on our homepage www.ticket-b.de.



Publications

Thomas Michael Krüger

Architectural Guide - Collector's Edition (Band Berlin), DOM Publishers, 2017

Das Berliner Regierungsviertel, Deutscher Kunstverlag, 2014

Die Berliner Museumsinsel, DOM Publishers, 2013

50 Jahre Hansaviertel Berlin, Eigenverlag Berlin, 2007

mit Peter Knoch, Marnie Schaefer: Architekturstadtplan Berlin, Verlagshaus Braun, 2002

Der Berlin-Erklärer, Architektur-Reihe im Berliner Kurier, 2015/2016

Architekturführer Karl-Marx-Allee Berlin, Infobox, Krematorium, Akademie der Künste, Velodrom, Schwimmhalle, Britische Botschaft, Ozeaneum Stralsund, Siemensstadt, Weiße Stadt, Stadtwandelverlag Berlin, 1999/2015

Claus Käpplinger

Neues Arbeiten und Wohnen am Hafen - Das Quartier Große Elbstraße in Hamburg, Junius Verlag, 2015

Ulf Meyer

Architekturführer Tokio, DOM Publishers, 2010

Architekturführer Helsinki, DOM Publishers, 2012

Bauhaus 1919-1933, Prestel, 2006

Jörn Köppler

Die Poetik des Bauens, transcript Verlag, 2016

Sinn und Krise moderner Architektur: Zeitgenössisches Bauen zwischen Schönheitserfahrung und Rationalitätsglauben, transcript Verlag, 2010

ARCHITECTURAL OFFICES

Cepezed; David Chipperfield; Claus en Kaan; Axel Schultes Architekten, Miller Maranta, Kisho Kurokawa; Daniel Libeskind; gmp; kadawittfeld; czyborra klingbeil

ARCHITECTURAL ASSOCIATIONS AND TRADE ASSOCIATIONS

American Institute of Architects (AIA); AK Baden-Württemberg; AK Brandenburg; Zaragoza, Alicante Stockholm; BDA Düsseldorf; BDA Sachsen-Anhalt; IAA; International Academy of Architecture; Ordre des Architectes et des Ingenieurs-Conseils; Royal Institute of Dutch Architects; Rechtsanwaltskammer NRW e.V.



Selection of References 1996 – 2018

PUBLIC AUTHORITIES, INSTITUTIONS AND GOVERNMENT AGENCIES

Bornholms Regionskommune; Oberste Baubehörde des Bayerischen Staatsministeriums des Innern; City of Stavanger Culture and Planning Office; Hochbauamt Kanton Zürich; Rhein.-Bergische Siedlungsgesellschaft; Edward Yau, Hong Kong Minister of the Environment

CLUBS, SOCIETIES AND ASSOCIATIONS

Academy of Building Research; DAAD; Goethe-Institut Berlin; Fraunhofer Institut; Lions Club Wiesbaden; Rotary Club Darmstadt, Braunschweig, Düsseldorf; Handelskammer Tokio; Fellows of Contemporary Art; Frauen in der Immobilienwirtschaft e.V.

FIRMS, INSTITUTES AND CONVENTIONS

Bene AG; BMW AG; Brillux; Bulthaupt; DBV Winterthur; DLW, Deutsche Linoleumwerke; Goldman Sachs; Henkel; HILTI Konzernforschung; Hyatt Berlin; JP Morgan; LB Berlin; Larry Silverstein, World Trade Center NY; Lufthansa Consulting Köln; Siemens Arts Programme; StoDesign; Wilkhahn Asia Pacific; Würth Industrie Service; Schüco International

JOURNALISTS AND MEDIA

AD Architectural Digest; Architectural Review; Baumeister, CallweyVerlag München; DIE ZEIT; Frankfurter Presseclub; HÄUSER; Handelsblatt, Kingshill Publications Ltd.; Madame; Schöner Wohnen; UFA; ZDF; Baunetz

UNIVERSITIES, COLLEGES, ACADEMIES AND SCHOOLS

Bauhaus-Universität Weimar; HfbK Hamburg; HafenCity Universität Hamburg; Hogeschool Maastricht; Lund University Schweden; Oxford Brookes University Summer School; Ingenieurschule Zürich; TFH Bern; European Business School; American Academy in Berlin; RWTH Aachen; ETH Zürich; Karlsruher Institut für Technologie; Universität Gent; Die Angewandte Wien; Frankfurt University; Universität Hannover; HS Koblenz

‘We were all impressed by the substantial knowledge of your tour guides. Their enthusiasm for Berlin and its architecture was tangible and catching.’

Arthur E. Miller, American Institute of Architects, Hong Kong, AIA conference

‘We saw and learned so much in such a short time during our truly comprehensive survey of Berlin’s “new Mitte”. It was wonderful, many thanks!’

Anna Diehl, KZA Koschany, Zimmer & Assoziierte GmbH

‘We learnt a great deal, which will undoubtedly improve our project. It has confirmed a lot of things in our own minds and helped us demonstrate to our clients the kind of innovations we were trying to put into practice.’

Rodney Grosskopf, MHG&L Architects and Planners, Sandown GB

‘Goethe claimed that best way to gain an education is through travelling. From our experience he should add: if one is guided and accompanied by Thomas Krüger. Your knowledge, organisational skills and rhetoric talent made our excursion to Berlin a unique experience.’

Gerhard Haisch, BDA Bayern

‘Great Job!’

David Chipperfield

What our clients say ...

‘I was amazed how much information is hidden in a single building. Thank you for the lively and convincing explanations. Your enthusiasm for architecture certainly ‘bubbled over’ to your listeners.’

A pupil from Friedrich Wilhelm Gymnasium, Königs Wusterhausen

‘It completely changed my idea about Berlin. You really brought the city to life, and of course there really is so much new ‘life’ there now.’

Lynne Jackson, The Architectural Review

‘A highly interesting and very inspiring afternoon. The 3 hours flew by – places revealed themselves to us in a manner I have not yet experienced.’

Matthias Kutscha, Siemens AG

Energy Sector

‘Competent guides, interesting topics and the bicycle tour was an extraordinary experience. This way we were taken to parts of the city where we would normally not have ventured.’

Helmut Wellmann, Siemens AG

Industry Sector

‘Thank you for the great guided tour of Hansaviertel/IBA – it was exactly what we wanted and the students were very appreciative.’

John Stevenson, Oxford Brookes University

‘Your knowledge, your ability to convey it as well as your perfect eloquence ensured us a superb day.’

C. Lang, Winterthur Versicherungen